

PARTS LIST

TUBULAR GOODS FRAME

Table of Contents

- TUBULAR GOODS FRAME SASH..... *BF-1*
- TUBULAR GOODS FRAME GAUGE..... *BF-2*

Part Nos. of screws, nuts, washers etc. are listed at the end of volume.

[Explanation of Marks #'s and *'s at End of Part No.1]

- ◆ Please specify, in the following manner, your machine model, manufacturing number and embroidery space when you order us with the parts having **** at the end of the part No.:

| | | | |
|------------|-----------|--------------|------------|
| Ex. | TME-DC915 | (360X360)S | No.01234 |
| | [Model] | [Emb. Space] | [Mfg. No.] |

- ◆ Please specify the number of needles on your machine's head in your parts order by changing the marks #### into one of the 4-digit numbers below:

| | | |
|------------|-------------------------------|-------------------|
| Ex. | The part Number, EF012345#### | |
| | 4-digit Numbers | Machine Type |
| | 0300..... | 3-needle machine |
| | 0600..... | 6-needle machine |
| | 0900..... | 9-needle machine |
| | 1200..... | 12-needle machine |

TUBULAR GOODS FRAME SASH

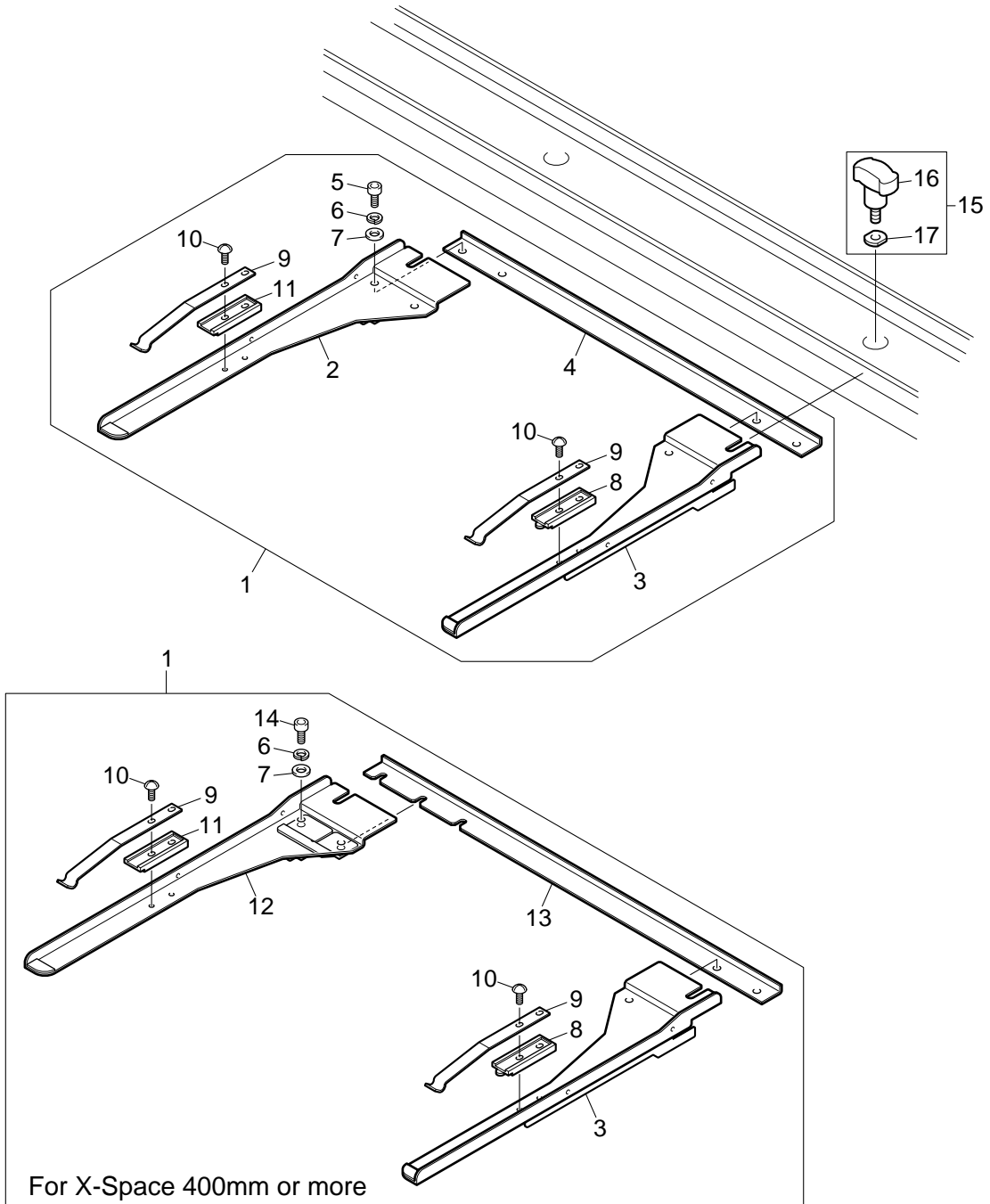

TUBULAR GOODS FRAME SASH

BF-1

| Ref.No. | Description | Part No. | Remark |
|---------|---|--------------|--------------------|
| 1 | Common Use Frame Tubular Goods Frame Sash | UN320035**** | |
| 2 | Holder Arm L | BF0A50L00000 | For TME-DC |
| 2 | Holder Arm L | BF0A55L0**** | For TMFN-C, TMFD-C |
| 3 | Holder Arm R | BF0A50R00000 | For TME-DC |
| 3 | Holder Arm R | BF0A55R0**** | For TMFN-C, TMFD-C |
| 4 | Arm Joint Angle | BF0A49000275 | For X-Space 275mm |
| 4 | Arm Joint Angle | BF0A49000360 | For X-Space 360mm |
| 5 | Hexagon Socket Head Cap Screw | SS6204100TD0 | M4*10 |
| 6 | Spring Washer | WSS040000KD0 | M4 |
| 7 | Plain Washer | WSP04A008SD0 | M4*10*0.8t |
| 8 | Positioning Plate A | BF1321A00000 | |
| 9 | Frame Presser Spring | BF1318010000 | |
| 10 | Truss Head Screw | SS0103080SD0 | M3*8 |
| 11 | Positioning Plate B | BF1321B00000 | |
| 12 | Adjustable Holder Arm L | BF0A51000000 | For TME-DC |
| 12 | Adjustable Holder Arm L | BF0A5600**** | For TMFN-C, TMFD-C |
| 13 | Arm Joint Angle | BF0A49000400 | For X-Space 400mm |
| 13 | Arm Joint Angle | BF0A49000460 | For X-Space 460mm |
| 13 | Arm Joint Angle | BF0A49000500 | For X-Space 500mm |
| 14 | Hexagon Socket Head Cap Screw | SS6204120TD0 | M4*12 |
| 15 | Frame Set Screw A Set | BF0A16S10000 | |
| 16 | Frame Set Screw A | BF0A16010000 | |
| 17 | Set Screw Spacer A | WH0A12000000 | |
| 18 | | | |
| 19 | | | |
| 20 | | | |
| 21 | | | |
| 22 | | | |
| 23 | | | |
| 24 | | | |
| 25 | | | |
| 26 | | | |
| 27 | | | |
| 28 | | | |
| 29 | | | |
| 30 | | | |
| 31 | | | |
| 32 | | | |
| 33 | | | |
| 34 | | | |
| 35 | | | |
| 36 | | | |
| 37 | | | |
| 38 | | | |
| 39 | | | |
| 40 | | | |
| 41 | | | |
| 42 | | | |
| 43 | | | |
| 44 | | | |

Note: As for parts with marks # or *, please follow our instructions on Table of Contents in your parts order.

(CG10)

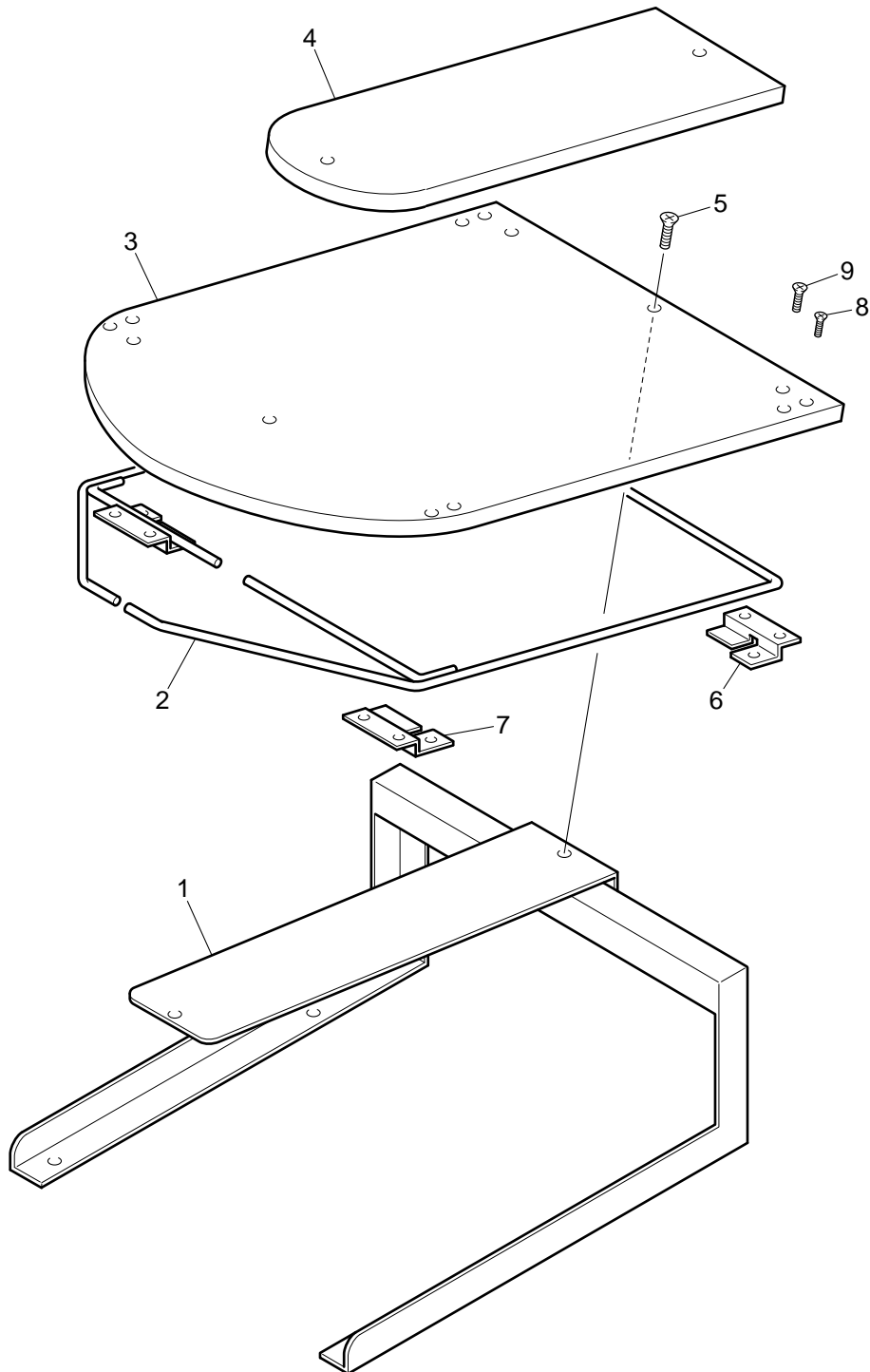

TUBULAR GOODS FRAME GAUGE

BF-2

| Ref.No. | Description | Part No. | Remark |
|---------|------------------------|--------------|-------------------|
| 1 | Gauge Base | BF0301010000 | |
| 2 | Fabric Stretching Arm | BF0303000000 | |
| 3 | Front Body Part Base | BF0304000000 | |
| 3 | Front Body Part Base | BF0304000500 | For X-Space 500mm |
| 4 | Arm Base | BF0305000000 | |
| 5 | Countersunk Head Screw | SS1106350SD0 | M6*35 |
| 6 | Arm Support AL | BF0306L00000 | |
| 7 | Arm Support AR | BF0306R00000 | |
| 8 | Countersunk Head Screw | SS1103160SD0 | M3*16 |
| 9 | Countersunk Head Screw | SS1104220SD0 | M4*22 |
| 10 | | | |
| 11 | | | |
| 12 | | | |
| 13 | | | |
| 14 | | | |
| 15 | | | |
| 16 | | | |
| 17 | | | |
| 18 | | | |
| 19 | | | |
| 20 | | | |
| 21 | | | |
| 22 | | | |
| 23 | | | |
| 24 | | | |
| 25 | | | |
| 26 | | | |
| 27 | | | |
| 28 | | | |
| 29 | | | |
| 30 | | | |
| 31 | | | |
| 32 | | | |
| 33 | | | |
| 34 | | | |
| 35 | | | |
| 36 | | | |
| 37 | | | |
| 38 | | | |
| 39 | | | |
| 40 | | | |
| 41 | | | |
| 42 | | | |
| 43 | | | |
| 44 | | | |
| 45 | | | |
| 46 | | | |
| 47 | | | |
| 48 | | | |
| 49 | | | |

Note: As for parts with marks # or *, please follow our instructions on Table of Contents in your parts order.

(CG03)

1st Revision (9903) March, 1999
2nd Revision (9910) October, 1999

■ **Manufactured by:**
Tokai Industrial Sewing Machine Co., Ltd.

NO.1800, Ushiyama-cho, Kasugai, Aichi-pre., 486-0901, Japan
Telephone:568-33-1161 Fax:568-33-1191

■ **Distributed by:**
Tajima Industries Ltd.

19-22, Shirakabe, 3-chome, Higashi-ku, Nagoya, 461-0011, Japan
Telephone:52-932-3444 Fax:52-932-2457

■ **Authorized Distributor:**