

Für den professionellen Anwender

Ersatzteilkatalog

For the professional user

Spare parts catalogue

Klasse: VEB100-1 Ausf. 1
Class: VEB100-2 Ausf. 1
Ausführung: VEB100-4 Ausf. 1
Model: VEB100-5 Ausf. 1

Maschinen-Nr.:
Machine number:

Stand:
Dated:

STROBEL
Spezialmaschinen GmbH



Sie finden die Strobel-Schutzmarke auf jeder Strobel-Maschine, die unser Werk verlässt. Und das aus gutem Grund. Denn dieses Zeichen garantiert Ihnen die hohe Qualität unserer Produkte. Qualität, die Vertrauen schafft – in unsere Technik, unseren Service und nicht zuletzt in unseren guten Namen.

The sign of quality

Y*ou find the Strobel trademark on every Strobel machine leaving our works. And with good reason. This symbol is a guarantee of the high quality of our products. Quality which creates trust – trust in our technology, our service and, not least of all, in our good name.*

VEB 100

VEB100-1

VEB100-2

VEB100-4

VEB100-5

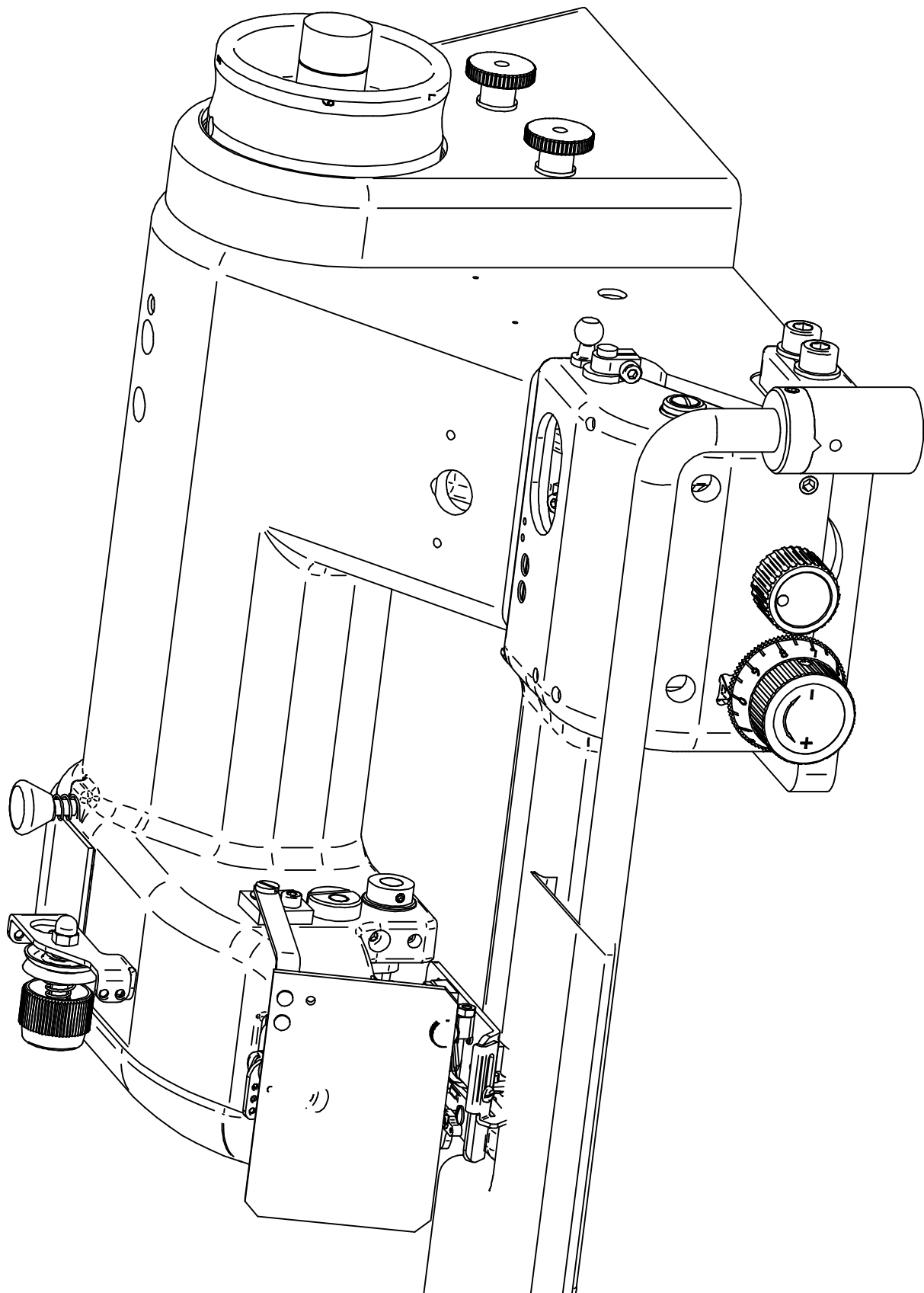

- Deckel
112.0504

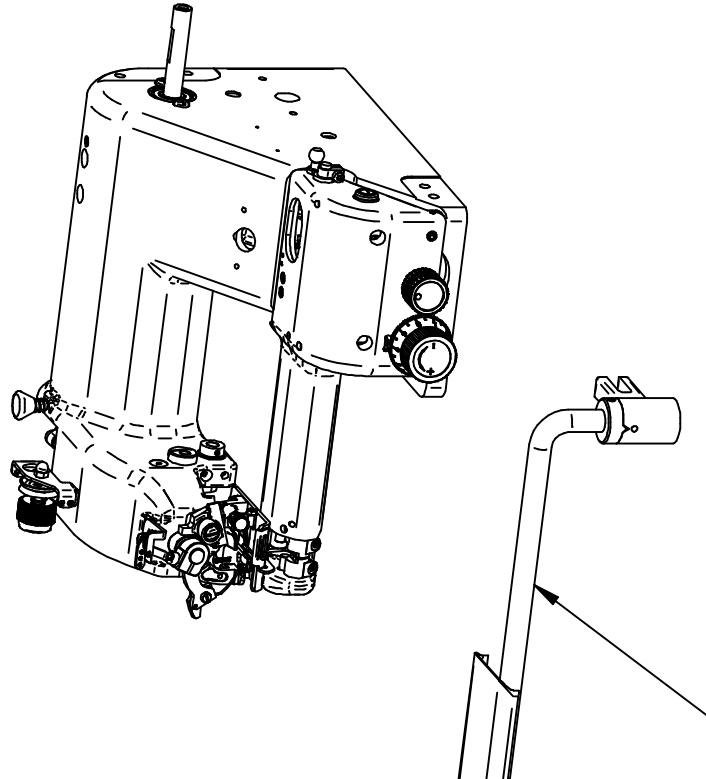

Anbausatz für Untertischmontage 00000.2813

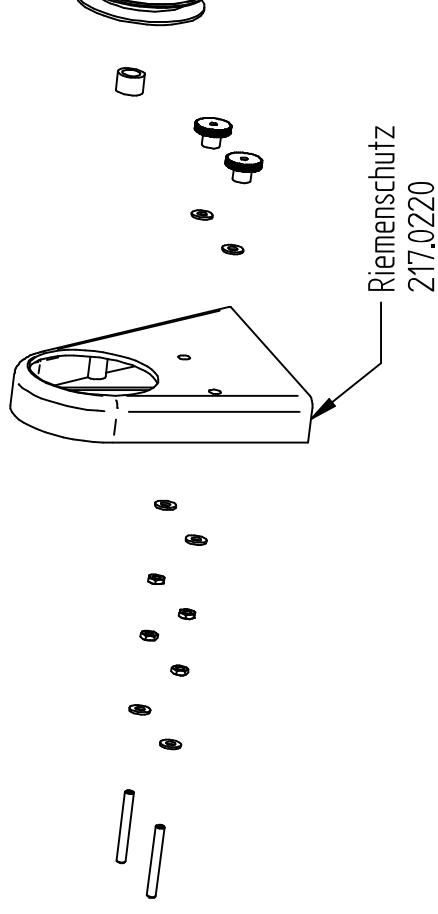

Anbausatz für Kompaktmotor 00000.2473

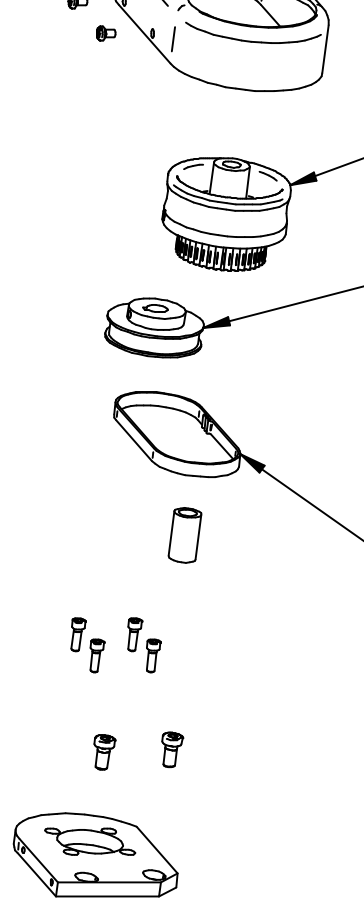

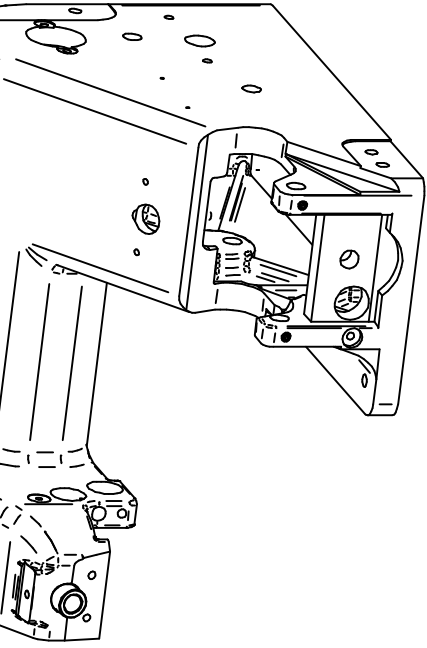

Hauptwelle
130.04.76

Kugellager
252.0048

Stellring
246.0021

VEB100-4
246.0194

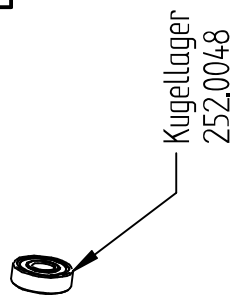

Kugellager
252.0048

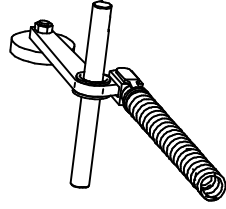
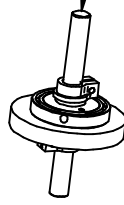
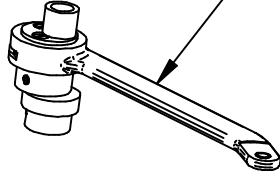

Details auf Seite 4 + 5

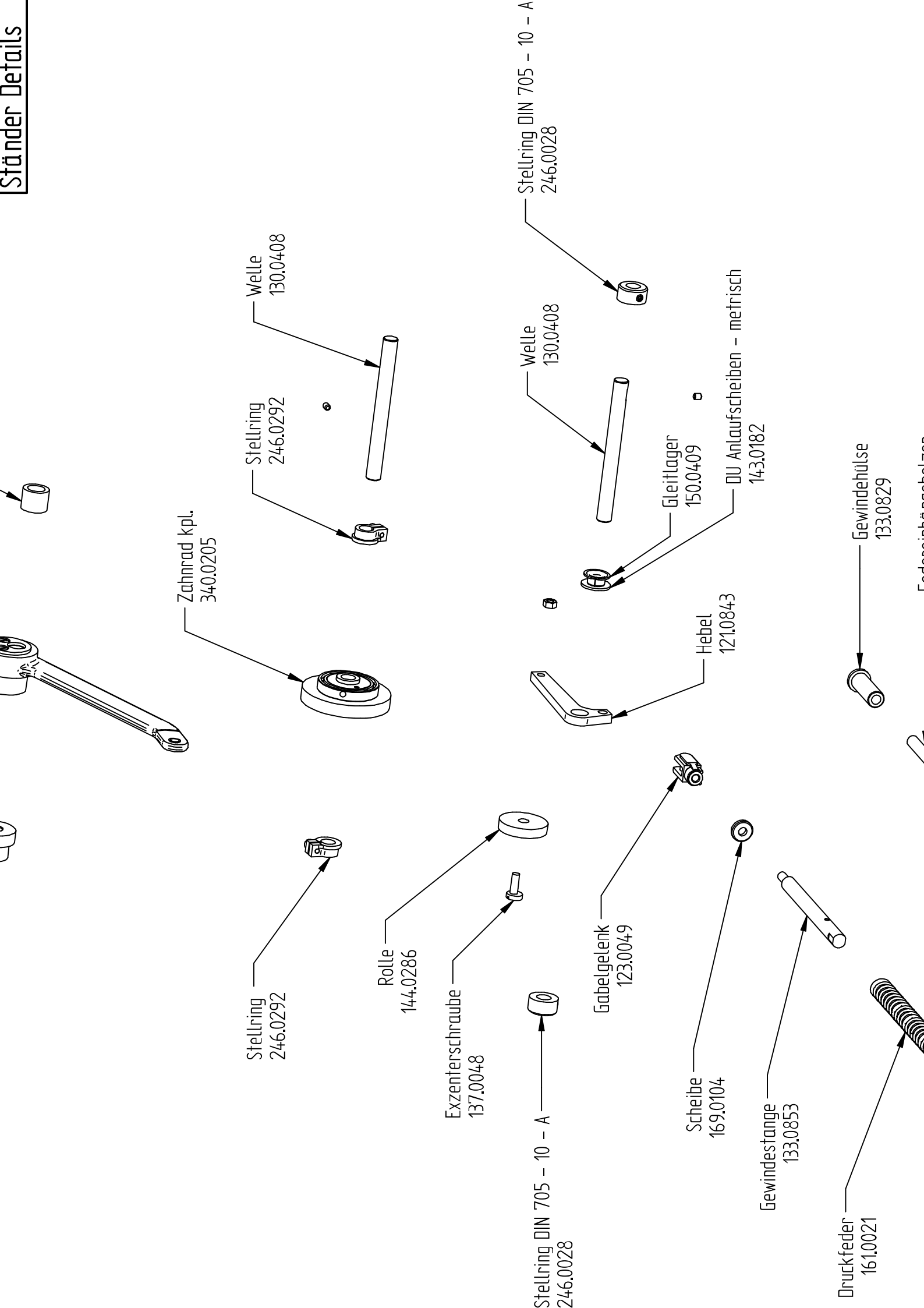

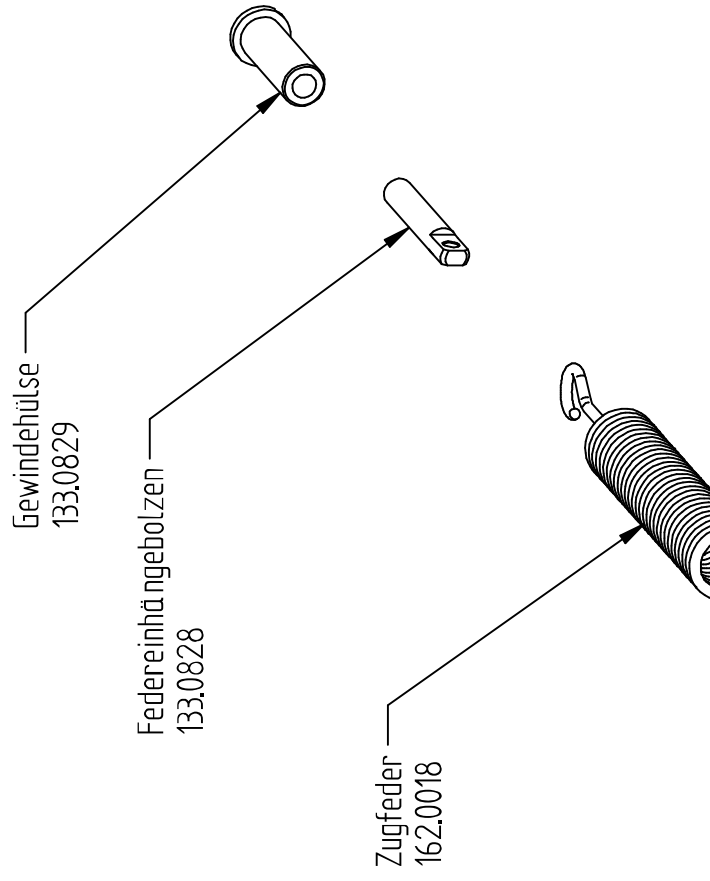
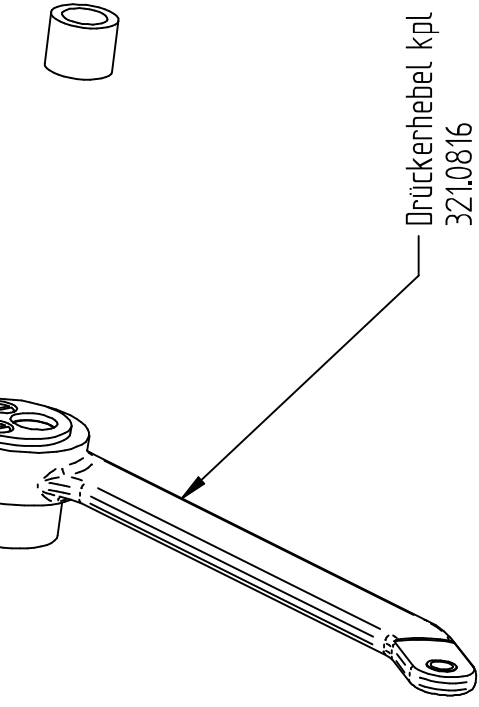

Nadelwelle
230.0048

Buchse mit Bund
150.0159

Stelling
246.0292

Buchse
150.0161

Stichplatte kpl. 4,5
280.0282

Details auf Seite 12 bis 15

Details auf Seite 7

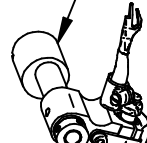
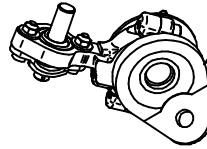
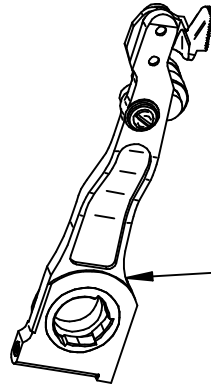
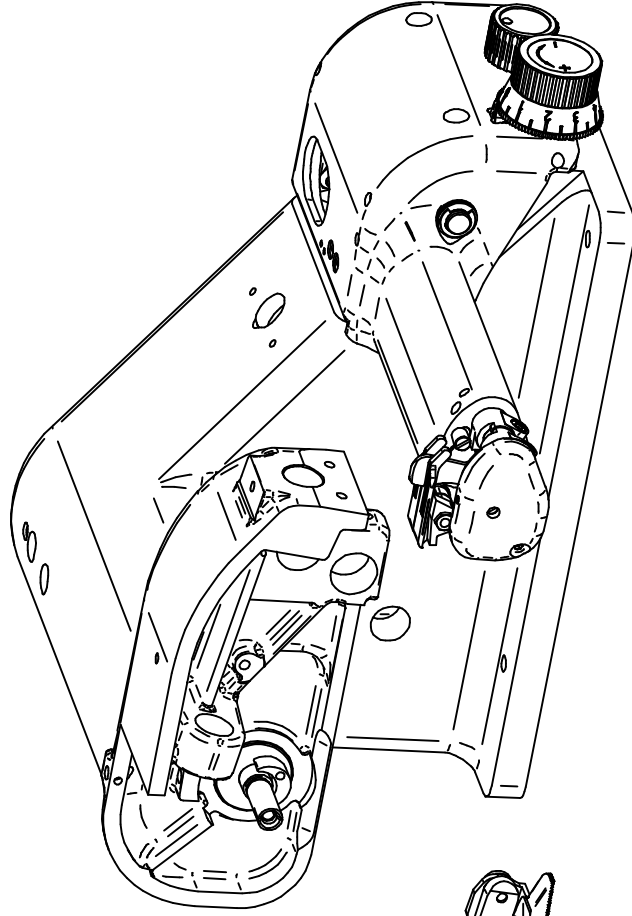

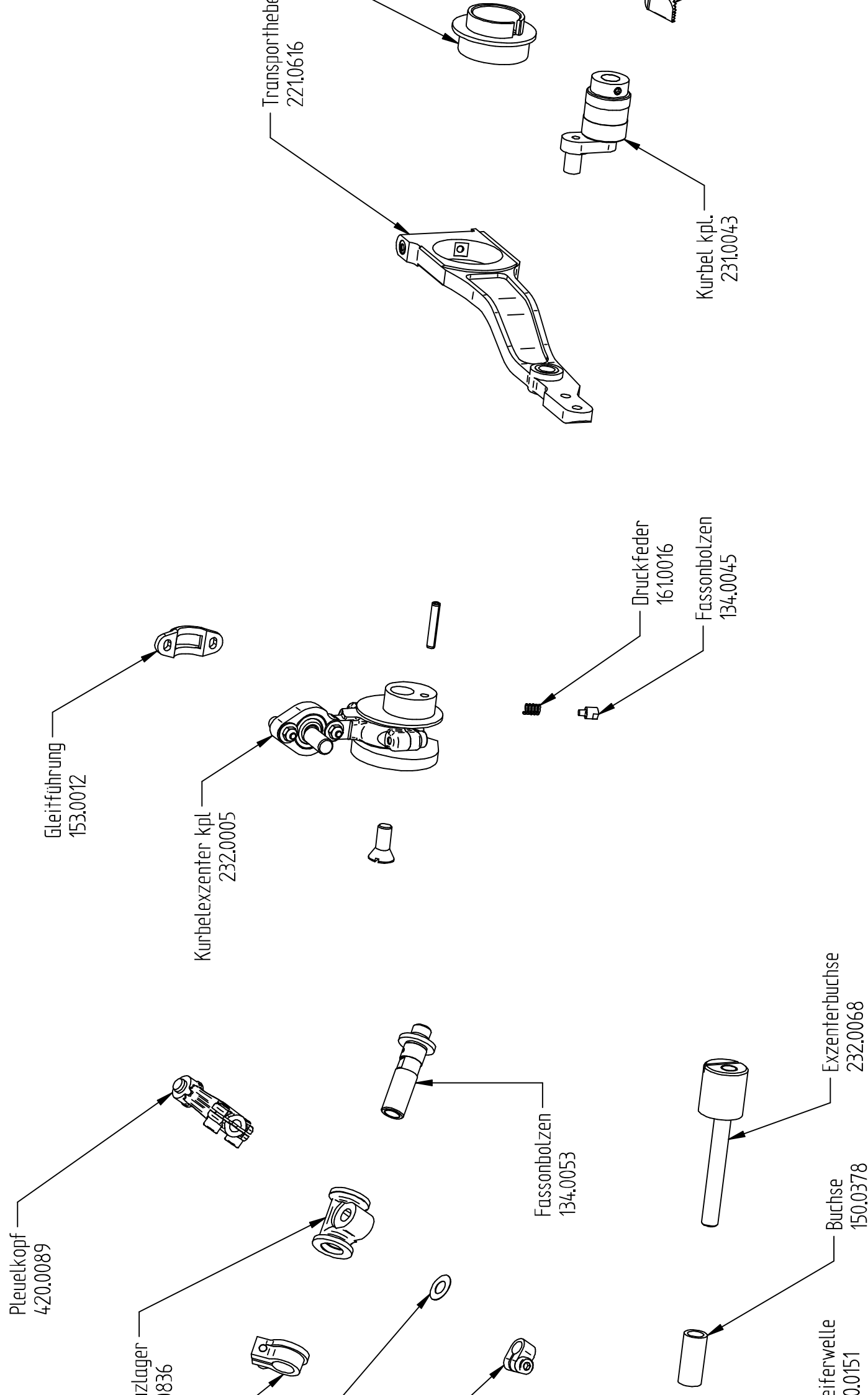

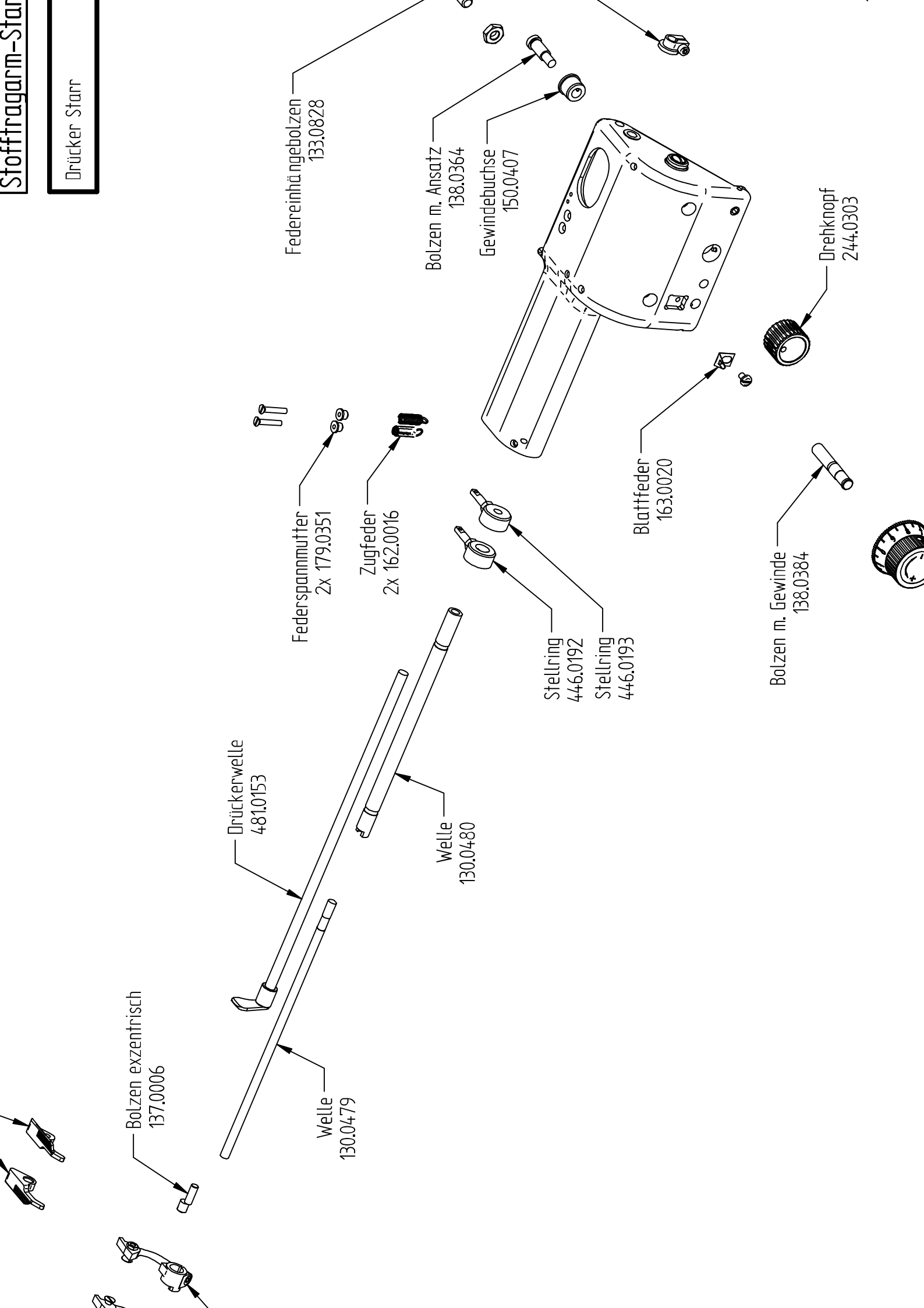

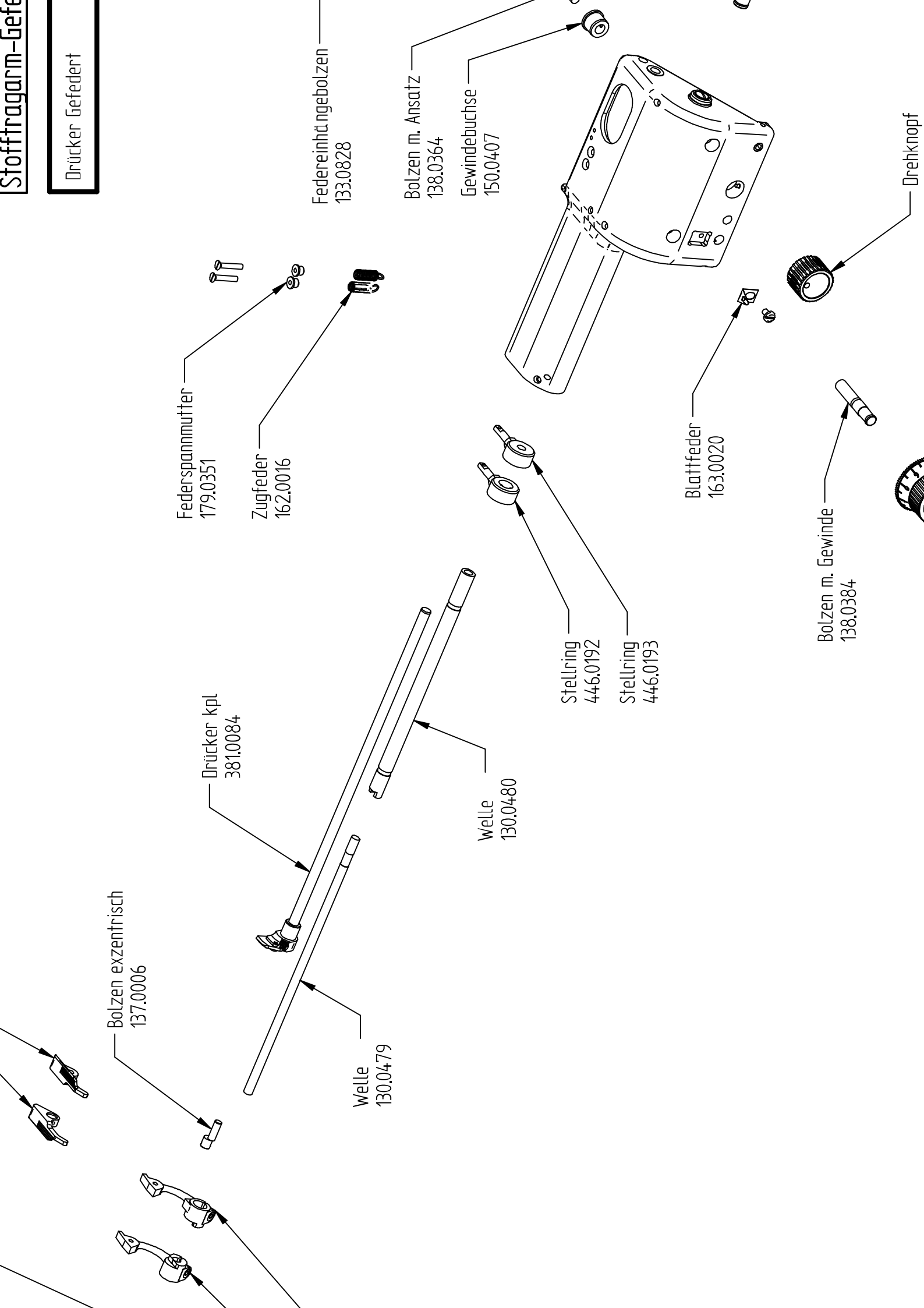

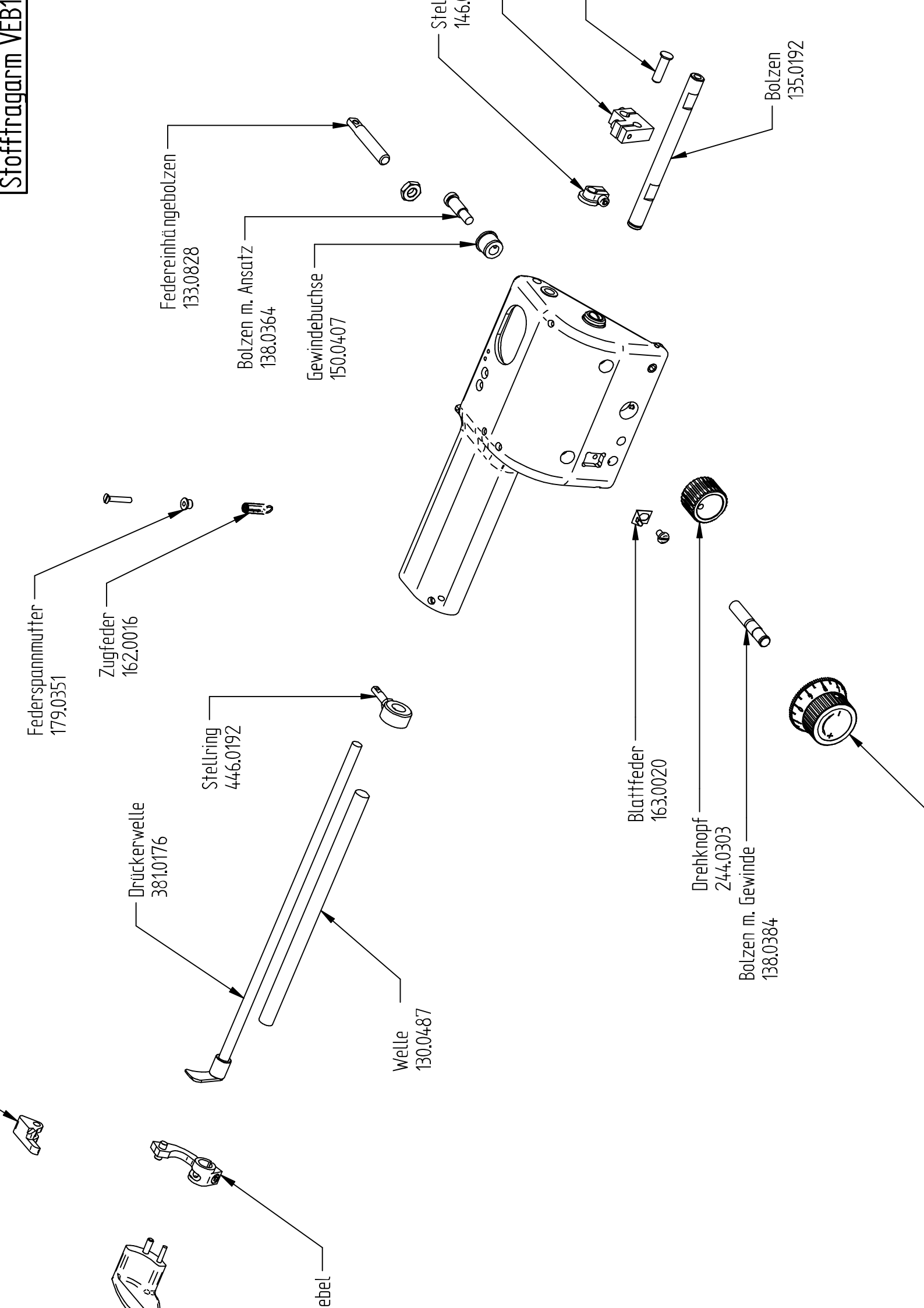

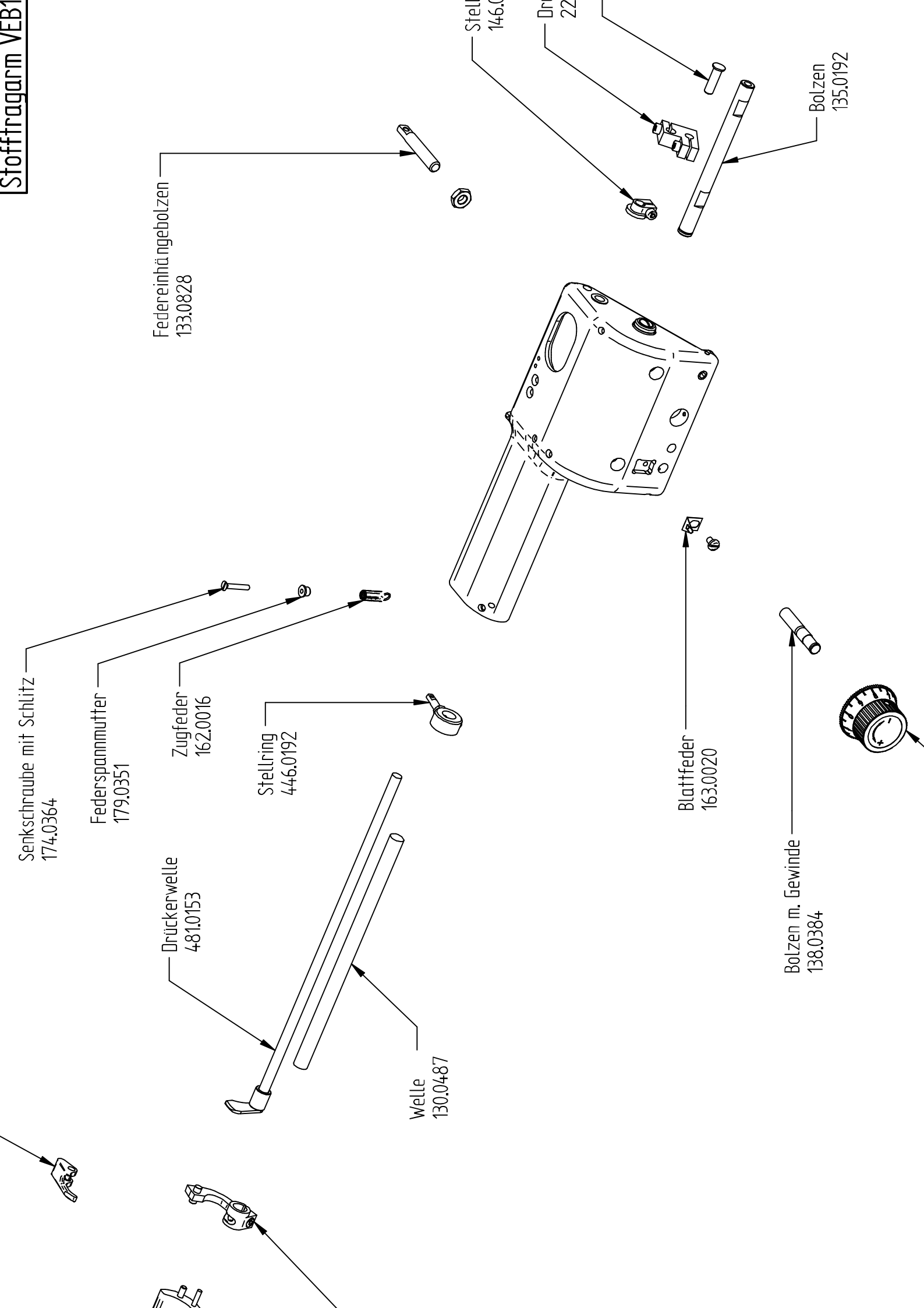

Stichplatte 4,5

Stichplatte 4,5mm

280.0282

Nadelführung rechts
185.0196

Nadelführung, links
185.0195

Hebel
121.0100

Fe
17

terialführung
186.0433

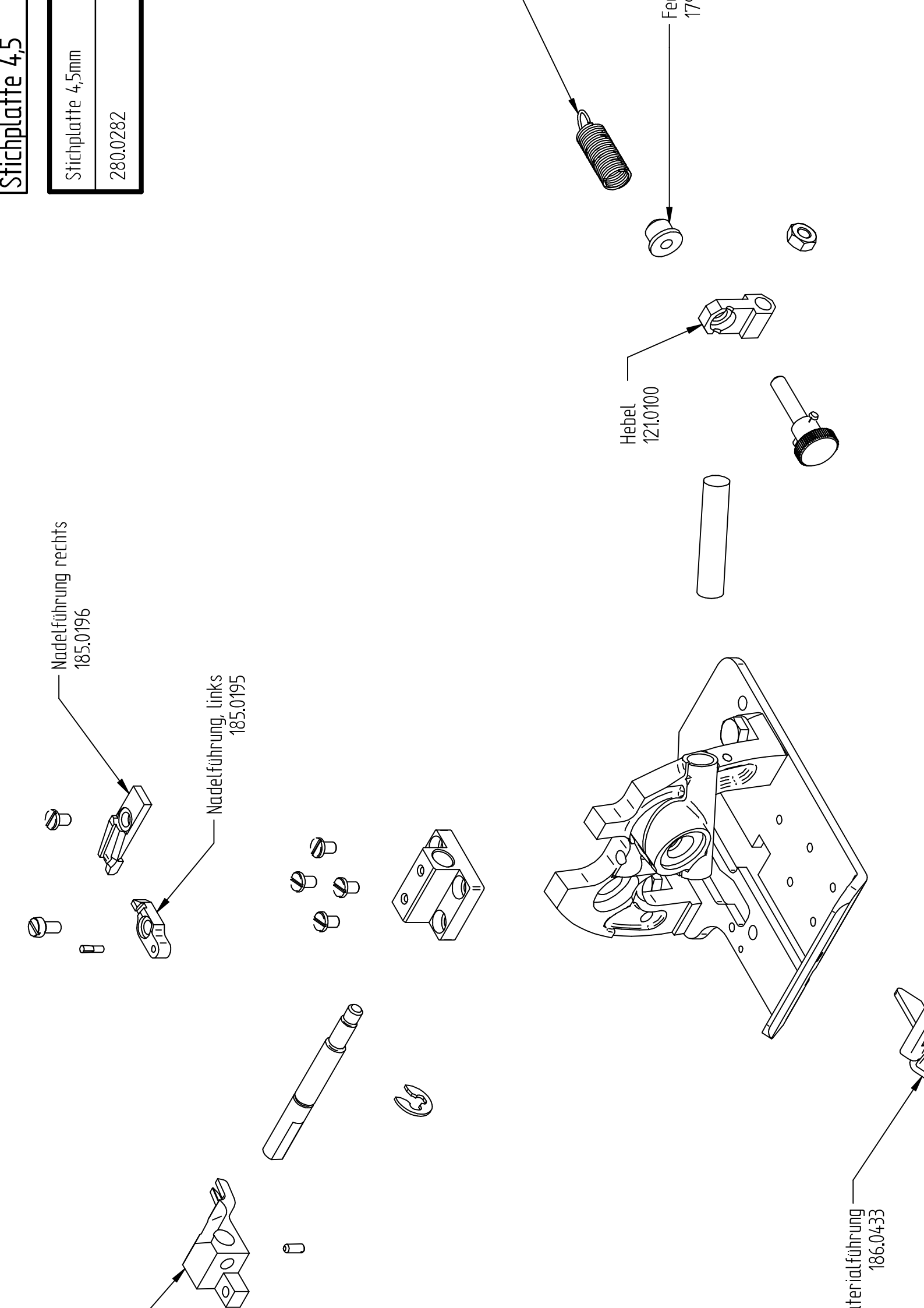

Stichplatte 4,5

Stichplatte 4,5mm

380.0282

Nadelführung rechts
185.0196

Nadelführung, links
185.0195

Hebel
121.0100

Federspann
179.0351

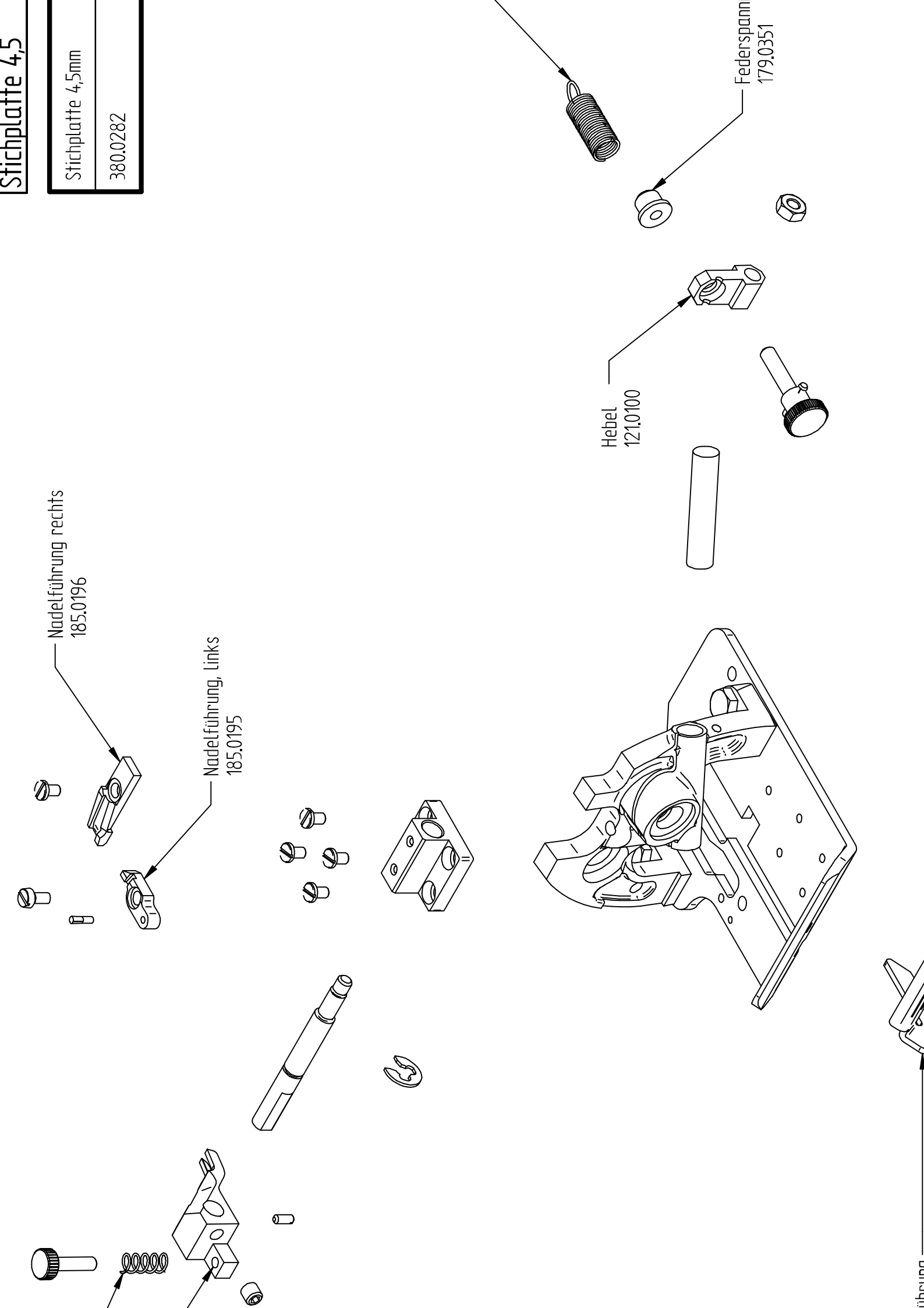

380.0275	Stir	

185.0190

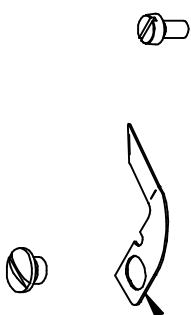
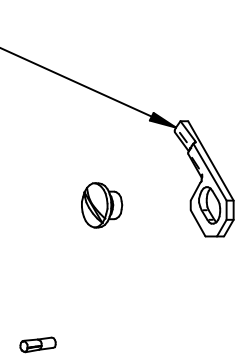

Sperrzahn
188.0238

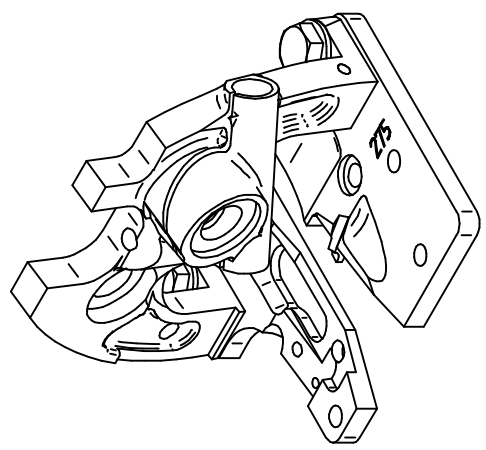

Kettelfinger
184.0001

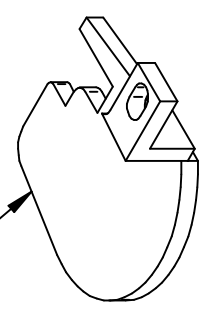
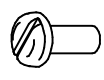
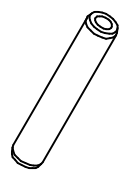
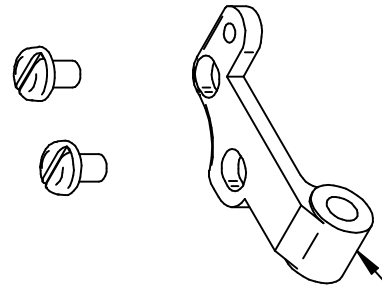

480.0250	Stichp	
----------	--------	--

Nadelführung
185.0103



Nadelführung, links
185.0107

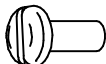
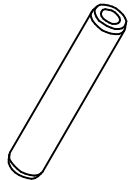
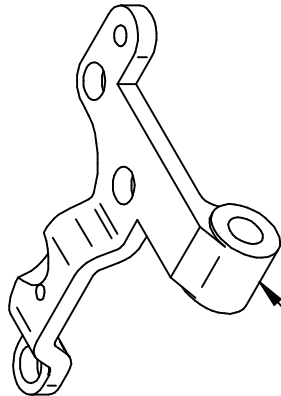
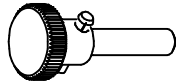
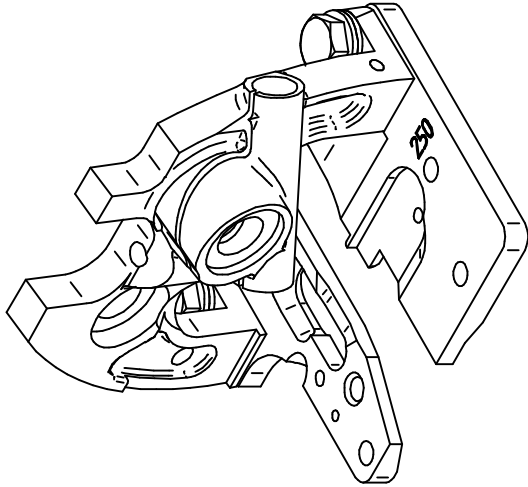

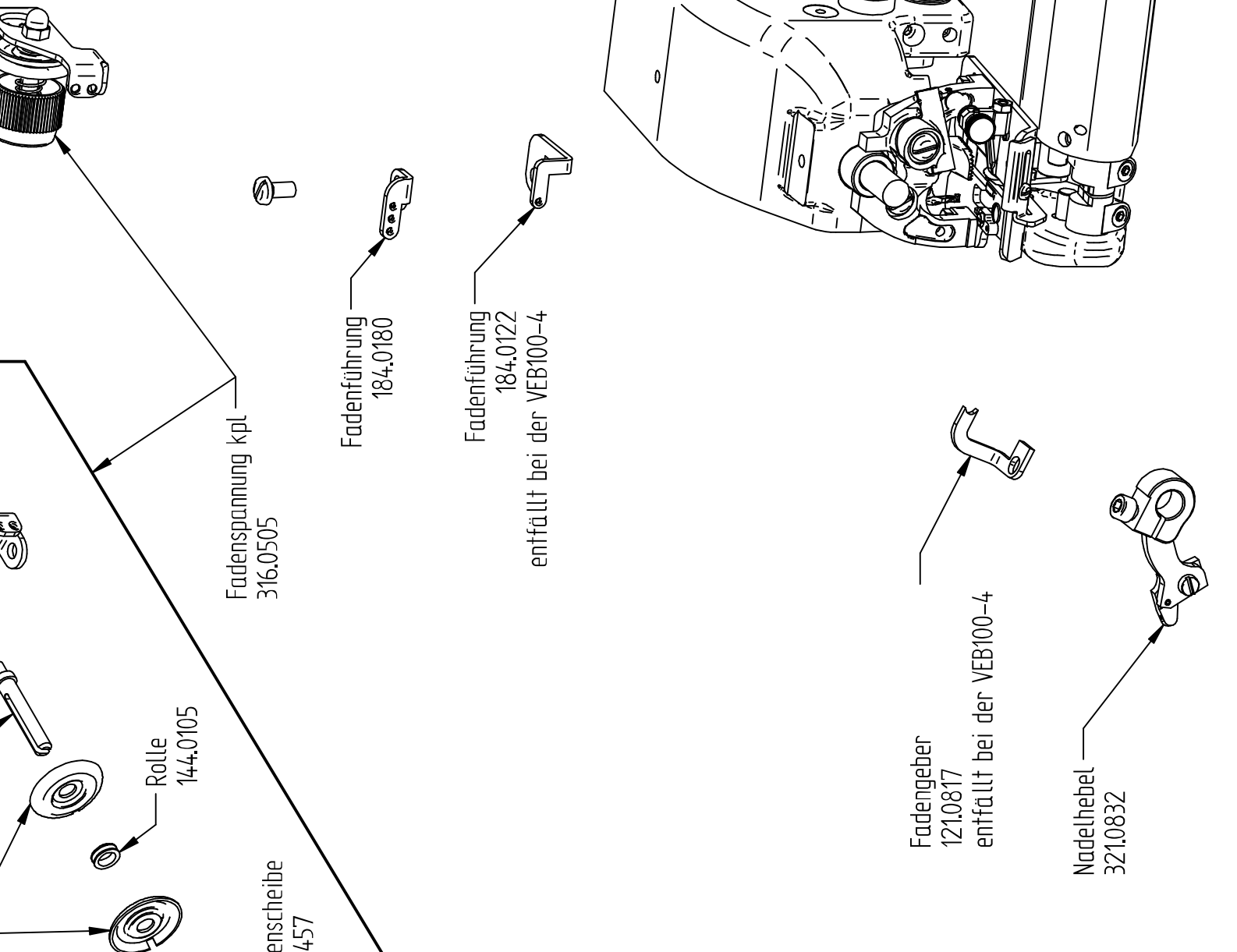

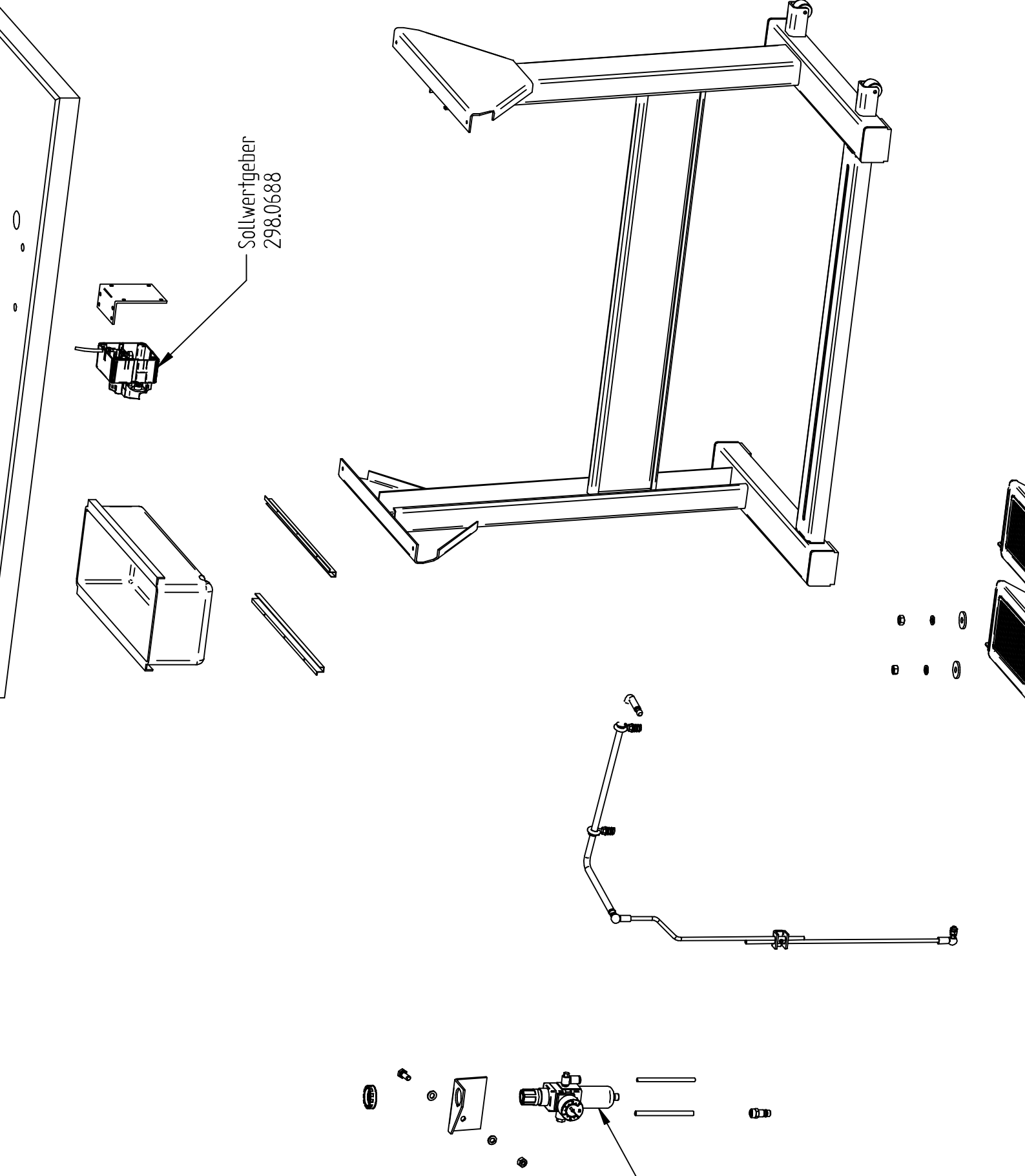

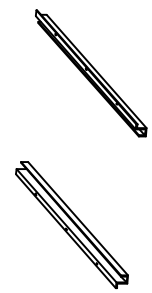
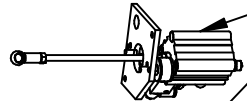
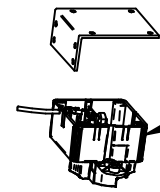
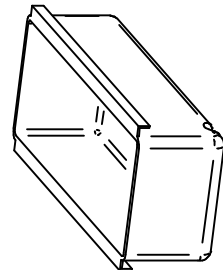
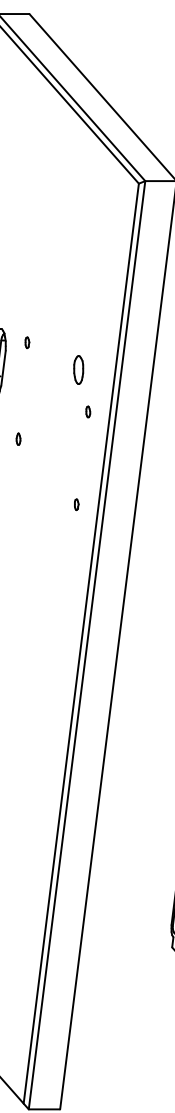

Details auf Seite 19

Sollwertgeber
298.0688

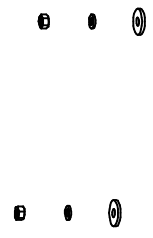
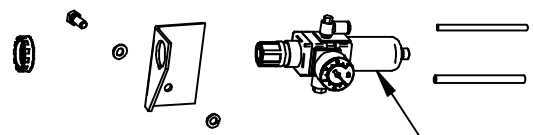
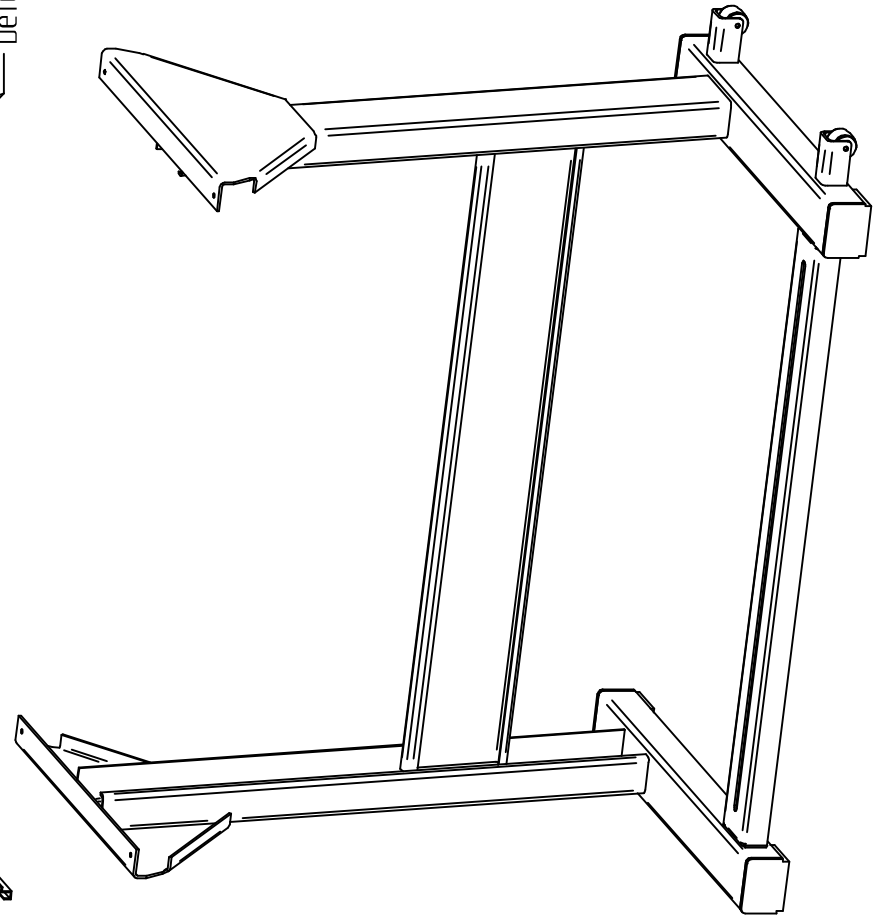

Schalldämpfer
293.0469

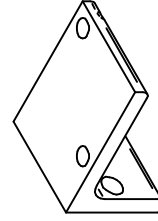
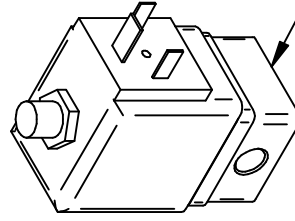
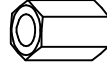

Matte
298

Pneumatikschlauch 6
193.0473

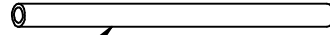

L-Einschraubanschluss
293.0850

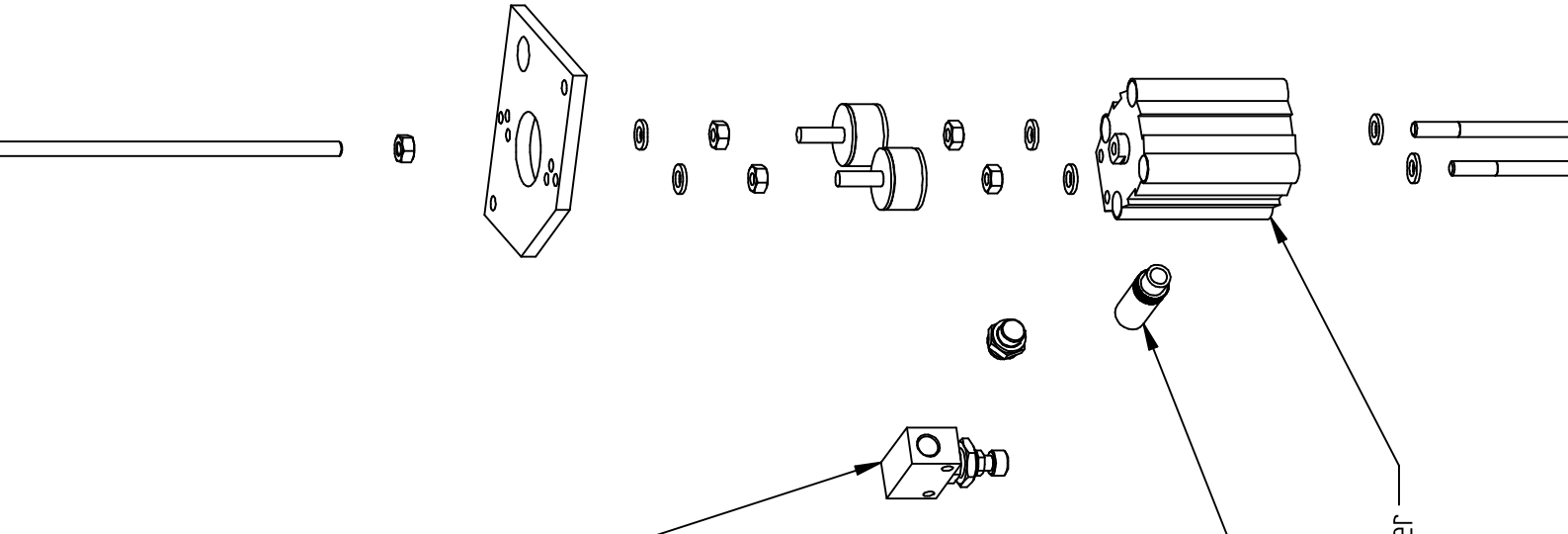
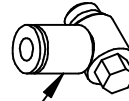

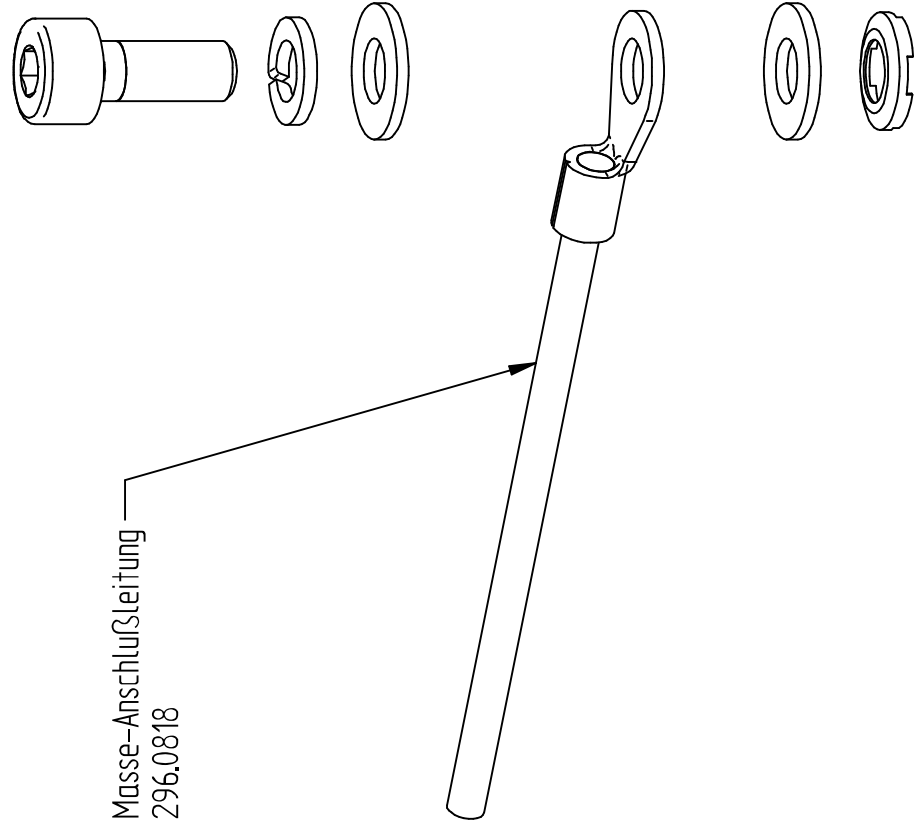

Fadenabschneider

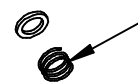
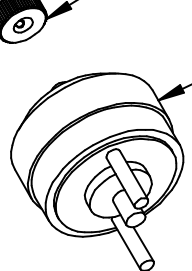
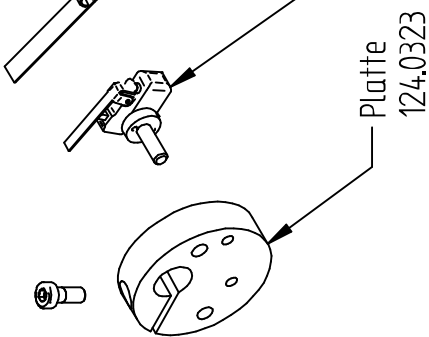
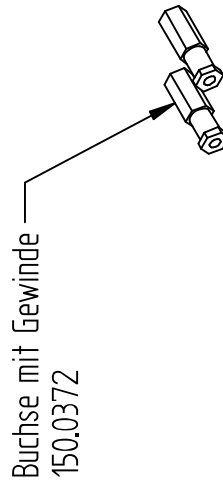
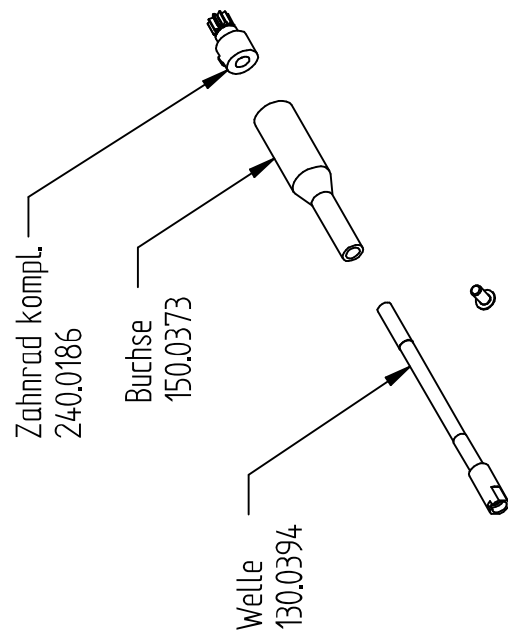
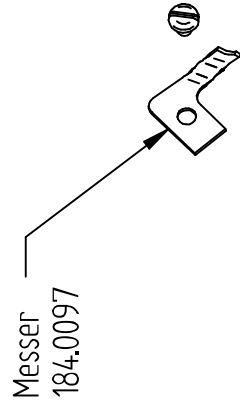
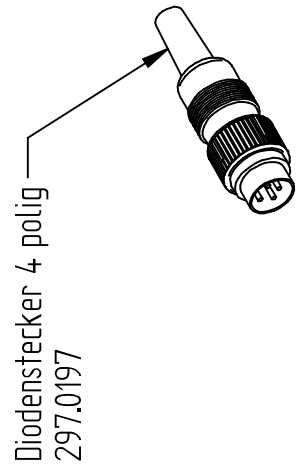

Und wir können noch mehr für Sie tun!

Unser Lieferprogramm bietet für jede Branche und jegliche Anforderung genau die richtige Problemlösung.

And we can do a lot more for you!

Our range offers the correct problem solution for every branch and for all requirements.

■ Für die Bekleidungs- industrie:

Ein- und Zweifaden-
Hochleistungs-Saummaschinen

Doppelblindstich-
Saummaschinen

Zweifaden-Blindstich-
Staffiermaschinen

Roll- und Flachpikiermaschinen

Pikier-Automat

und

weitere Spezial-Nähmaschinen

■ *For the clothing industry:*

*Single and two thread high
performance hemming
machines*

Bluff edge hemming machines

*Two thread blind stitch felling
machines*

Roll and flat padding machines

*Automatic lapel padding
machine*

*and other special sewing
machines*

■ Für die Schuh- verarbeitung:

Einfaden-Überwendlich-
maschinen mit und ohne
Differentialtransport

■ *For the shoe industry:*

*Single-thread overseaming ma-
chines with and without differen-
tial feed*

■ Für Kürschnereien und Pelzkonfektion:

Pelzschnellnäher

Pelzpikiermaschine

Futterstaffiermaschine

■ *For the fur industry:*

Rapid fur sewing machines

Fur padding machine

Lining felling machine

■ Für Heimtextilien:

Ein- und Zweifaden-
Blindstichmaschinen

■ *For the home textiles industry:*

*Single and two thread
blind stitch machines*

■ Für die Polster- verarbeitung:

Ein- und Zweifaden-
Überwendlichmaschinen

Ein- und Zweifaden-
Blindstichmaschinen

■ *For the upholstery industry:*

*Single and two thread
overseaming machines*

*Single and two thread
blind stitch machines*

■ Für die Konfektion technischer Textilien:

Ein- und Zweifaden-
Überwendlichmaschinen

■ *For the processing of technical textiles:*

*Single and two thread
overseaming machines*

Noch Fragen?

Dann rufen Sie uns an, schreiben Sie uns oder kommen Sie einfach bei uns vorbei.

Sie können jederzeit weitere Informationen über unsere Produkte anfordern oder die Strobel-Nähmaschinen in unserem Ausstellungsraum live erleben. Wir freuen uns auf Sie!

Any further questions?

Then phone, write or simply come and see us. You can have further information about our products at any time, or experience the Strobel machines live in our show room. We're looking forward to meeting you!

STROBEL

Spezialmaschinen GmbH

Postfach 1242
82168 Puchheim
Siemensstraße 3
82178 Puchheim
DEUTSCHLAND

www.strobel.biz
Telefon: +49 89 80096-0
Telefax: +49 89 80096-190