

**SINGER**  
**17U130,U141,U142**

**MACHINE PARTS CHART**  
**for**  
**SINGER\***

**17U130**  
**17U141**  
**17U142**

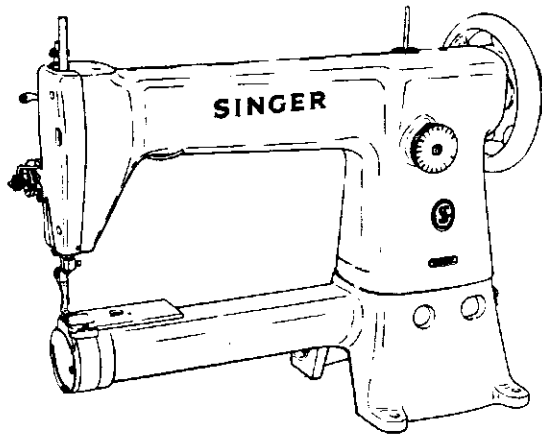

# SINGER\*

## 17U141

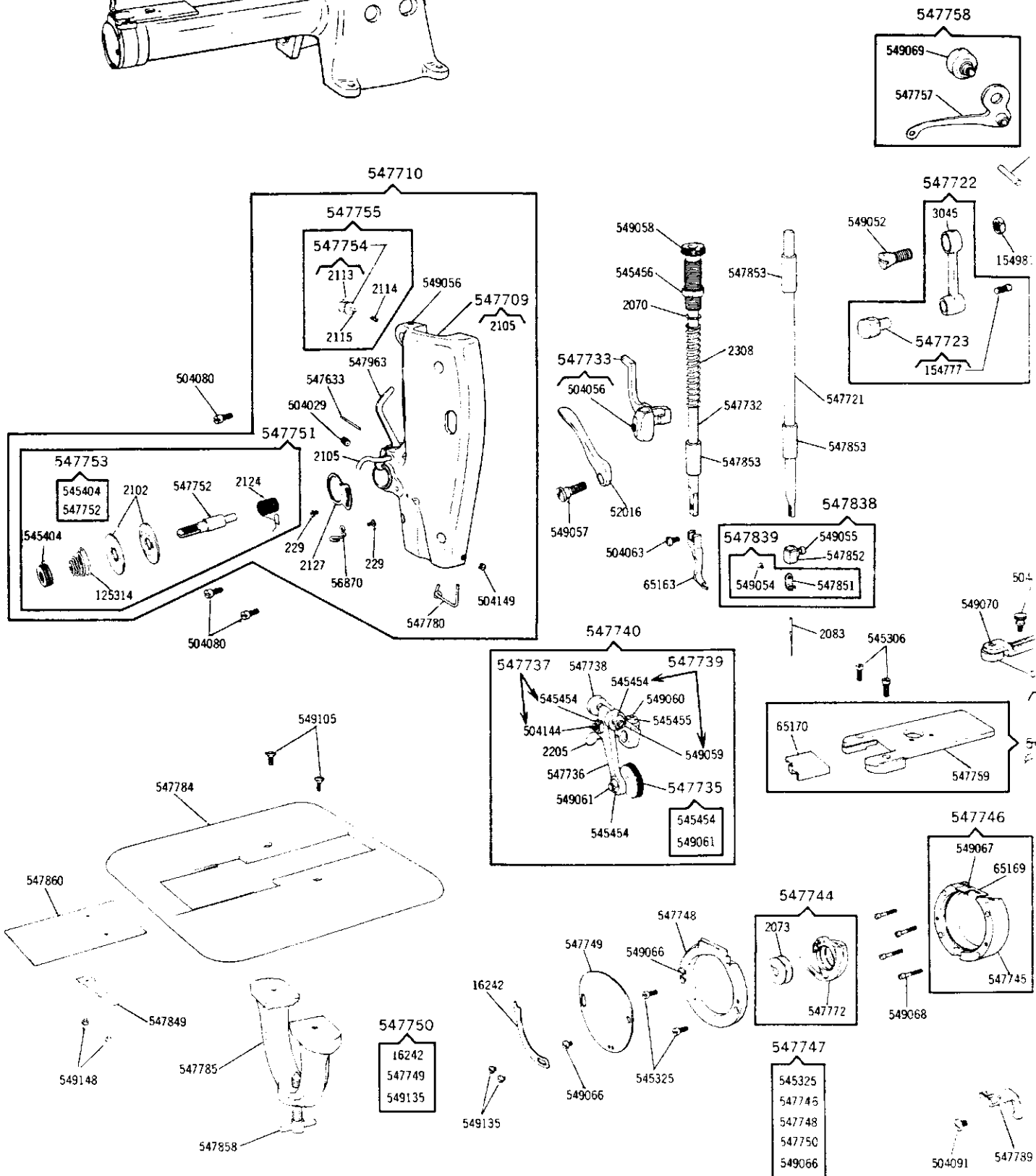

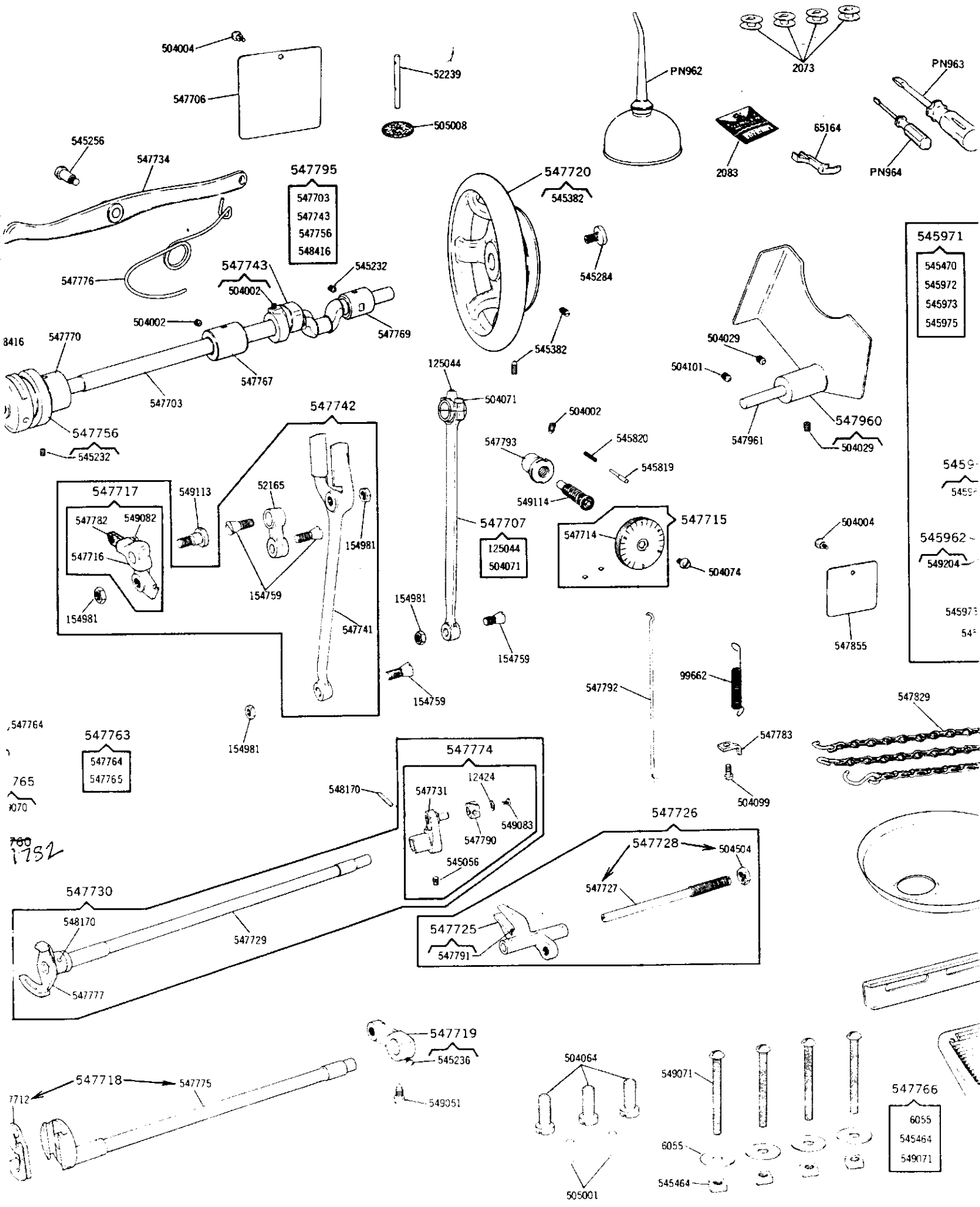

# NUMERICAL LIST OF PARTS FOR MACHINES 17U130, 17U141 AND 17U142

## CLOTH PLATE FOR MACHINES 17U130 AND 17U141

PART NO.	DESCRIPTION
547784	Cloth Plate
547785	Cloth Plate Bracket
547858	Cloth Plate Bracket Set Screw
549105 (853)	Cloth Plate Screw (2)
547860	Cloth Plate Slide
547849	Cloth Plate Slide Spring
549148 (832)	Cloth Plate Slide Spring Screw (2)

## CLOTH PLATE FOR MACHINE 17U142

PART NO.	DESCRIPTION
549706	Cloth Plate
547857	Cloth Plate Bracket
547858	Cloth Plate Bracket Set Screw
549105 (853)	Cloth Plate Screw (2)
547860	Cloth Plate Slide
547849	Cloth Plate Slide Spring
549148 (832)	Cloth Plate Slide Spring Screw (2)
549708	Cloth Plate Washer (2)

## ROLLER PRESSER FOR MACHINES 17U130 AND 17U141

PART NO.	DESCRIPTION
547735	Roller with 549061 (810) and 545454 (809)
547736	Roller Arm
504144 (810)	Roller Arm Adjusting Screw
547737	Roller Arm Adjusting Screw 504144 (810) with 545454 (809)
545454 (809)	Roller Arm Adjusting Screw Nut
547738	Roller Arm Bracket
2205	Roller Arm Lock Spring
549060 (810)	Roller Arm Lock Spring Screw
545455 (809)	Roller Arm Lock Spring Screw Nut
549059 (810)	Roller Arm Screw Center (2)
547739	Roller Arm Screw Center 549059 with 545454 (809)
545454 (809)	Roller Arm Screw Center Nut (2)
547740	Roller Presser complete, (7/8" fine roller) Nos. 2205, 545455 (809), 547735, 547736, 547737, 547738, 549060 (810) and two 547739
549061 (810)	Roller Screw
545454 (809)	Roller Screw Nut

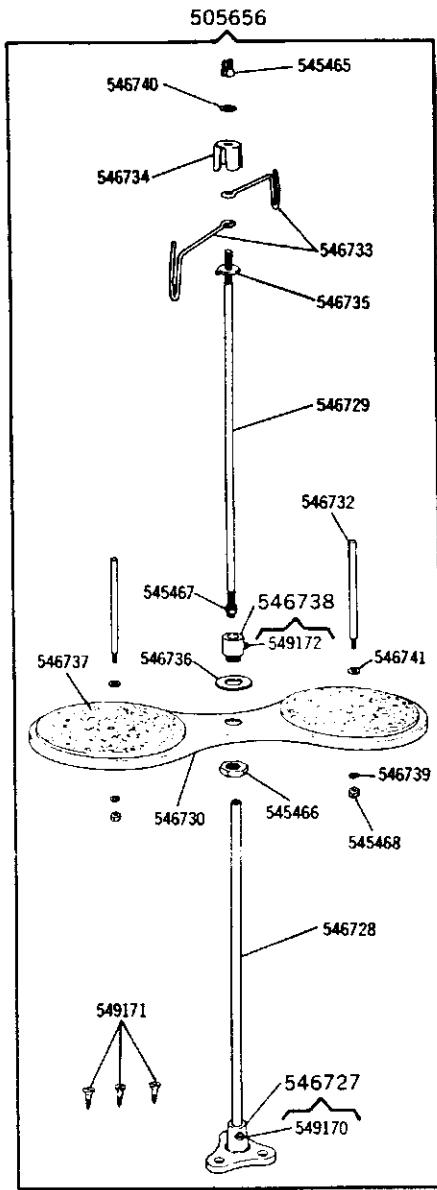
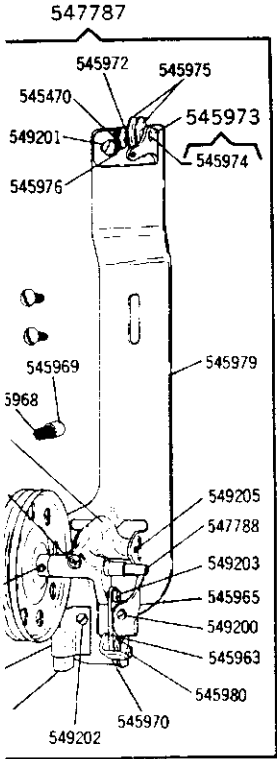
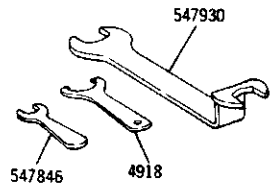

**PARTS ONLY FOR MACHINE**

**17U130**

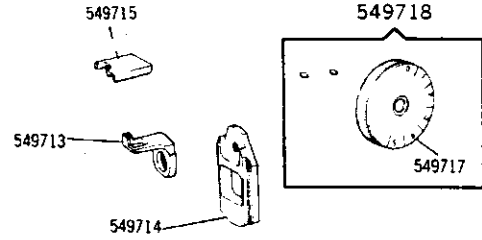

**PARTS ONLY FOR MACHINE**

**17U142**

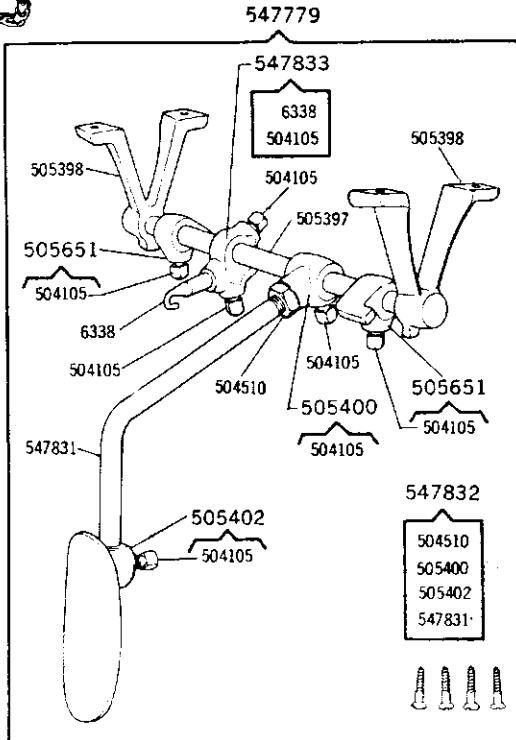
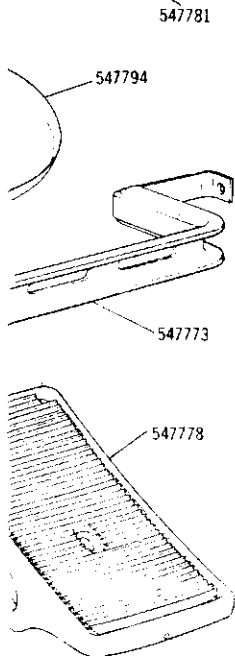
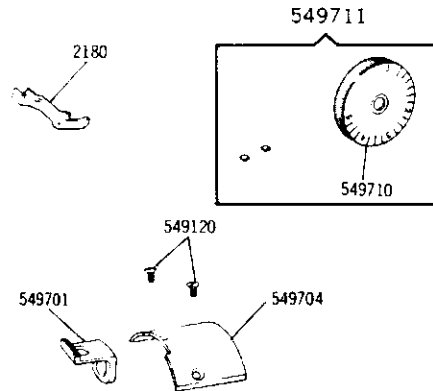

549703

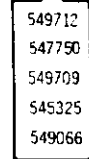

549712

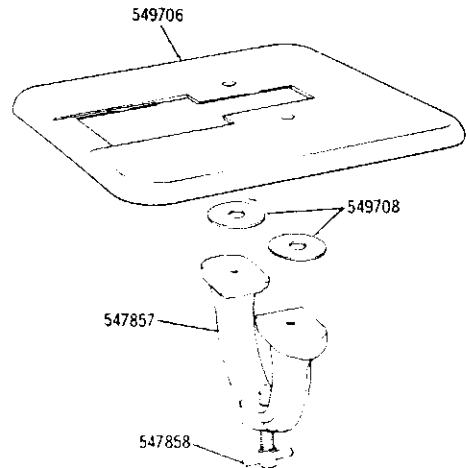
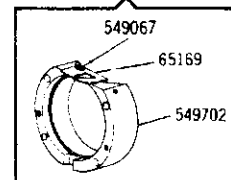

# NUMERICAL LIST OF PARTS FOR MACHINES 17U130, 17U141 AND 17U142

## ACCESSORIES FOR MACHINE 17U142

PART NO.	DESCRIPTION
547794	Drip Pan
547781	Feed Reverse Lever Chain
547778	Feed Reversing Treadle complete
549071 (809)	Machine Bolt (4)
547766	Machine Bolt 549071 (809) with 545464 (809) and 6055
545464 (809)	Machine Bolt Nut (4)
6055	Machine Bolt Washer (4)
547773	Motor Treadle Lever
2083 (16×2)	Needle (6)
PN962	Oiler (filled with Singer Type "B" Oil)
2180	Presser Foot
PN963	Screw Driver (large)
PN964	Screw Driver (small)
2073	Shuttle Bobbin (4)
4918	Wrench (for 545456)
547930	Wrench (for 154981)
547846	Wrench (for 545454 and 545455)

## KNEE LIFTER PARTS FOR MACHINES 17U130, 17U141 AND 17U142

PART NO.	DESCRIPTION
547829	Presser Bar Lifter Lever Chain
505397	Rock Shaft
547779	Rock Shaft complete, Nos. 505397, 547832, 547833 and two each 505651, 505398 and four Wood Screws (1 in. No. 10)
505398	Rock Shaft Hanger (2)
547831	Rock Shaft Knee Arm
547832	Rock Shaft Knee Arm complete, Nos. 504510 (809), 547831, 505400 and 505402
504510 (809)	Rock Shaft Knee Arm Clamping Nut
505400	Rock Shaft Knee Arm Hub with 504105 (809)
504105 (809)	Rock Shaft Knee Arm Hub Set Screw
505402	Rock Shaft Knee Plate with 504105 (809)
504105 (809)	Rock Shaft Knee Plate Set Screw
547833	Rock Shaft Lifting Bracket with 6338 and two 504105 (809)
6338	Rock Shaft Lifting Bracket Hook
504105 (809)	Rock Shaft Lifting Bracket Hook Set Screw
504105 (809)	Rock Shaft Lifting Bracket Set Screw
505651	Rock Shaft Stop Dog with 504105 (809)
504105 (809)	Rock Shaft Stop Dog Set Screw (2)

## BOBBIN WINDER FOR MACHINES 17U130, 17U141 AND 17U142

PART NO.	DESCRIPTION
547787	Universal Bobbin Winder complete, Nos. 545962, 545963, 545965, 545966, 545968, 545969, 545970, 545971, 545976, 545977, 545978, 545979, 547788, 549200 (819), 549201 (819), 549202 (819), 549203 (819), 549205 and two 545980 with two 5.5×19 Wood Screws

PART NO.	DESCRIPTION
545979	Bobbin Winder and Tension Bracket Base
545977	Bobbin Winder Brake
545978	Bobbin Winder Brake Clamp
549202 (819)	Bobbin Winder Brake Clamp Screw
545966	Bobbin Winder Frame with 545967
549205	Bobbin Winder Frame Hinge Pin
545967	Bobbin Winder Frame Oil Cup
545968	Bobbin Winder Frame Spring
545969	Bobbin Winder Frame Spring Plunger
545962	Bobbin Winder Pulley with 549204 (819)
549204 (819)	Bobbin Winder Pulley Set Screw
547788	Bobbin Winder Spindle
545965	Bobbin Winder Stop Latch
549200 (819)	Bobbin Winder Stop Latch Screw
545970	Bobbin Winder Stop Latch Thumb Lever
545980	Bobbin Winder Stop Latch Thumb Lever Hinge Stud (2)
545963	Bobbin Winder Stop Latch Trip Lever
549203 (819)	Bobbin Winder Stop Latch Trip Lever Hinge Screw
545973	Bobbin Winder Tension Bracket with 545974
545971	Bobbin Winder Tension complete, Nos. 545470 (819), 545972, 545973 and two 545975
549201 (819)	Bobbin Winder Tension Bracket Screw
545976	Bobbin Winder Tension Bracket Screw Washer
545975	Bobbin Winder Tension Disc (2)
545972	Bobbin Winder Tension Spring
545974	Bobbin Winder Tension Stud
545470 (819)	Bobbin Winder Tension Stud Thumb Nut Wood Screw 5.5×19 (2)

## THREAD UNWINDER FOR MACHINES 17U130, 17U141 AND 17U142

PART NO.	DESCRIPTION
505656	Thread Unwinder (for two spools) complete, Nos. 545465 (856), 545466 (856), 545467 (856), 546727, 546728, 546729, 546730, 546734, 546735, 546736, 546738, 546740, three 549171 and two each 545468 (856), 546732, 546733, 546737, 546739 and 546741
546732	Thread Unwinder Spool Pin (2)
545468 (856)	Thread Unwinder Spool Pin Nut (2)
546739	Thread Unwinder Spool Pin Spring Washer (2)
546741	Thread Unwinder Spool Pin Washer (2)
546738	Thread Unwinder Spool Rest Bushing with 549172 (850)
545466 (856)	Thread Unwinder Spool Rest Bushing Nut
546736	Thread Unwinder Spool Rest Bushing Nut Washer
549172 (850)	Thread Unwinder Spool Rest Bushing Set Screw
546737	Thread Unwinder Spool Rest Felt (2)
546730	Thread Unwinder Spool Rest (for two spools)
546728	Thread Unwinder Spool Rest Rod (lower)
549170 (828)	Thread Unwinder Spool Rest Rod (lower) Set Screw
546729	Thread Unwinder Spool Rest Rod (upper)
545467 (856)	Thread Unwinder Spool Rest Rod (upper) Nut
546727	Thread Unwinder Spool Stand with 549170 (828)
546733	Thread Unwinder Thread Guide (2)
545465 (856)	Thread Unwinder Thread Guide Lock Nut
546740	Thread Unwinder Thread Guide Lock Nut Spring Washer
546734	Thread Unwinder Thread Guide Position Cup
546735	Thread Unwinder Thread Guide Rod Washer
549171	Wood Screw No. 10×1 inch (3)

# NUMERICAL LIST OF PARTS FOR MACHINES 17U130, 17U141 AND 17U142

PART NO.	17U 17U 17U			DESCRIPTION	PART NO.	17U 17U 17U			DESCRIPTION
	130	141	142			130	141	142	
229 (809)	*	*	*	Face Plate Thread Guard (upper) Screw	545256 (850)	*	*	*	Presser Bar Lifter Lever Hinge Screw
229 (809)	*	*	*	Thread Take-up Spring Regulator Plate Adjusting Screw	545284 (802)	*	*	*	Arm Shaft Screw
2070	*	*	*	Presser Bar Spring Washer	545306 (805)	*	*	*	Throat Plate Holder Screw (2)
2073	*	*	*	Shuttle Bobbin	545325 (809)	*	*	*	Shuttle Race Ring Screw (2)
2102	*	*	*	Tension Disc (2)	545382 (850)	*	*	*	Machine Pulley Set Screw (2)
2105	*	*	*	Tension Thread Guard	545404 (856)	*	*	*	Tension Regulating Thumb Nut
2113	*	*	*	Thread Retaining Disc Steady Pin	545454 (809)	*	*	*	Roller Arm Adjusting Screw Nut
2114	*	*	*	Thread Retaining Spring	545454 (809)	*	*	*	Roller Arm Screw Center Nut (2)
2115	*	*	*	Thread Retaining Stud	545454 (809)	*	*	*	Roller Screw Nut
2124	*	*	*	Thread Take-up Spring	545455 (809)	*	*	*	Roller Arm Lock Spring Screw Nut
2127	*	*	*	Thread Take-up Spring Regulator Plate	545456 (851)	*	*	*	Pressure Regulating Thumb Screw Lock Nut
2205	*	*	*	Roller Arm Lock Spring	545819	*	*	*	Feed Regulating Stud Lock Pin
2308	*	*	*	Presser Bar Spring	545820	*	*	*	Feed Regulating Stud Lock Pin Spring
3045	*	*	*	Needle Bar Connecting Link	547633	*	*	*	Tension Releaser Hinge Pin
12424	*	*	*	Oscillating Shaft Crank Slide Block Cap Screw Washer	547703	*	*	*	Arm Shaft
16242	*	*	*	Shuttle Race Ring Cover Latch	547706	*	*	*	Arm Side Cover
52016	*	*	*	Presser Bar Lifter	547707	*	*	*	Crank Connecting Rod with 125044 and two 504071 (833)
52165	*	*	*	Feed Connecting Link	547709	*	*	*	Face Plate with 2105
52239	*	*	*	Arm Spool Pin and Thread Eyelet	547710	*	*	*	Face Plate complete, Nos. 504029 (833), 549056 (833), 504149 (809), 56870, 547780, 547755, 2127, 547633, 547963, 547751, 547709 and two 229 (809)
56870	*	*	*	Face Plate Thread Guard (upper)					
65163	*	*	*	Presser Foot (narrow toe)					
65169	*	*	*	Shuttle Race Thread Protector					
65170	*	*	*	Throat Plate	547712	*	*	*	Feed Dog Carrier
99662	*	*	*	Feed Reverse Lever Return Spring	547714	*	*	*	Feed Regulating Stud Head
125044	*	*	*	Crank Connecting Rod Oil Pad (felt)	547715	*	*	*	Feed Regulating Stud Head 547714 with two Feed Regulating Stud Head Stop Plate
125314	*	*	*	Tension Spring					
154759 (850)	*	*	*	Crank Connecting Rod Hinge Screw	547716	*	*	*	Feed Regulator
154759 (850)	*	*	*	Feed Connecting Link Hinge Screw (2)	547717	*	*	*	Feed Regulator 547716 with 547782 and 549082 (850)
154759 (850)	*	*	*	Feed Forked Connection Hinge Screw					
154777 (850)	*	*	*	Needle Bar Connecting Stud Set Screw	547718	*	*	*	Feed Rock Shaft 547775 with 547712
154981 (819)	*	*	*	Crank Connecting Rod Hinge Screw Nut	547719	*	*	*	Feed Rock Shaft Crank with 545236 (803)
154981 (819)	*	*	*	Feed Connecting Link Hinge Screw Nut (2)					
154981 (819)	*	*	*	Feed Forked Connection Hinge Screw Nut	547720	*	*	*	Machine Pulley with two 545382 (850)
154981 (819)	*	*	*	Needle Bar Connecting Link Hinge Screw Nut	547721	*	*	*	Needle Bar
504002 (850)	*	*	*	Arm Shaft Bushing (intermediate) Set Screw	547722	*	*	*	Needle Bar Connecting Link 3045 with 547723
504002 (850)	*	*	*	Feed Cam Set Screw	547723	*	*	*	Needle Bar Connecting Stud with 154777 (850)
504002 (850)	*	*	*	Feed Regulating Stud Bushing Set Screw	547725	*	*	*	Oscillating Rock Shaft with 547791
504004 (852)	*	*	*	Arm Side Cover Thumb Screw	547726	*	*	*	Oscillating Rock Shaft complete, Nos. 547725 and 547728
504004 (852)	*	*	*	Cylinder Side Cover Thumb Screw	547727	*	*	*	Oscillating Rock Shaft Hinge Pin
504029 (833)	*	*	*	Belt Safety Guard Set Screw (2)	547728	*	*	*	Oscillating Rock Shaft Hinge Pin 547727 with 504504 (819)
504029 (833)	*	*	*	Tension Screw Stud Set Screw	547729	*	*	*	Oscillating Shaft
504056 (830)	*	*	*	Presser Bar Lifter Bracket Set Screw	547730	*	*	*	Oscillating Shaft 547729 with 547774, 547777 and 548170
504063 (810)	*	*	*	Presser Foot Screw					
504063 (810)	*	*	*	Roller Presser Screw	547731	*	*	*	Oscillating Shaft Crank
504064 (805)	*	*	*	Arm Screw (3)	547732	*	*	*	Presser Bar
504071 (833)	*	*	*	Crank Connecting Rod Cap Screw (2)	547733	*	*	*	Presser Bar Lifter Bracket with 504056 (830)
504074 (850)	*	*	*	Feed Regulating Stud Head Cap Screw					
504080 (851)	*	*	*	Face Plate Screw (3)	547734	*	*	*	Presser Bar Lifter Lever
504091 (803)	*	*	*	Feed Dog Screw	547735	*	*	*	Roller with 549061 (810) and 545454 (809)
504099 (809)	*	*	*	Feed Reverse Lever Return Spring Bracket Screw	547736	*	*	*	Roller Arm
504101 (830)	*	*	*	Belt Safety Guard Shaft Set Screw	547737	*	*	*	Roller Arm Adjusting Screw 504144 (810) with 545454 (809)
504144 (810)	*	*	*	Roller Arm Adjusting Screw					
504149 (809)	*	*	*	Face Plate Thread Guard (lower) Screw	547738	*	*	*	Roller Arm Bracket
504504 (819)	*	*	*	Oscillating Rock Shaft Hinge Pin Lock Nut	547739	*	*	*	Roller Arm Screw Center 549059 (810) with 545454 (809)
505001	*	*	*	Arm Dowel Pin (2)	547740	*	*	*	Roller Presser complete, (7 8" fine roller, Nos. 2205, 545455 (809), 547735, 547736, 547737, 547738, 549060 (810) and two 547739
505008	*	*	*	Arm Spool Pin Washer (felt)					
545056 (833)	*	*	*	Oscillating Shaft Crank Set Screw					
545232 (833)	*	*	*	Arm Shaft Bushing (back) Set Screw	547741	*	*	*	Feed Forked Connection
545232 (833)	*	*	*	Thread Take-up Cam Set Screw					
545236 (803)	*	*	*	Feed Rock Shaft Crank Set Screw					



# NUMERICAL LIST OF PARTS FOR MACHINES 17U130, 17U141 AND 17U142

PART NO.	17U 17U 17U			DESCRIPTION	PART NO.	17U 17U 17U			DESCRIPTION
	130	141	142			130	141	142	
547742	*	*	*	Feed Forked Connection complete, Nos. 547741, 52165, 547717 and two each 154759 (850) and 154981 (819)	549054 (851)	*	*	*	Needle Clamp Inread Guide Screw
547743	*	*	*	Feed Cam with 504002 (850)	549055 (858)	*	*	*	Needle Clamp Screw
547744	*	*	*	Shuttle Bobbin 2073 with 547772	549056 (833)	*	*	*	Thread Retaining Stud Set Screw
547745	*	*	*	Shuttle Race (body)	549057 (810)	*	*	*	Presser Bar Lifter Screw
547746	*	*	*	Shuttle Race 547745 with 549067 (809) and 65169	549058 (851)	*	*	*	Pressure Regulating Thumb Screw
547747	*	*	*	Shuttle Race complete, Nos. 547750, 547746, 547748 and two each 545325 (809) and 549066 (810)	549059 (810)	*	*	*	Roller Arm Screw Center (2)
547748	*	*	*	Shuttle Race Ring	549060 (810)	*	*	*	Roller Arm Lock Spring Screw
547749	*	*	*	Shuttle Race Ring Cover	549061 (810)	*	*	*	Roller Screw
547750	*	*	*	Shuttle Race Ring Cover 547749 with 16242 and two 549135 (810)	549066 (810)	*	*	*	Shuttle Race Ring Cover Screw (2)
547751	*	*	*	Tension complete, Nos. 125314, 2124, 547753 and two 2102	549067 (809)	*	*	*	Shuttle Race Thread Protector Screw
547752	*	*	*	Tension Screw Stud	549068 (810)	*	*	*	Shuttle Race Screw (4)
547753	*	*	*	Tension Screw Stud 547752 with 545404 (856)	549069 (851)	*	*	*	Thread Take-up Lever Hinge Screw
547754	*	*	*	Thread Retaining Disc with 2113	549082 (850)	*	*	*	Feed Reverse Lever Set Screw
547755	*	*	*	Thread Retainer Guide complete, Nos. 547754, 2114 and 2115	549083 (809)	*	*	*	Oscillating Shaft Crank Slide Block Cap Screw
547756	*	*	*	Thread Take-up Cam with 545232 (833)	549113 (803)	*	*	*	Feed Regulator Hinge Screw
547757	*	*	*	Thread Take-up Lever with Roller and Roller Stud	549114 (803)	*	*	*	Feed Regulating Stud
547758	*	*	*	Thread Take-up Lever 547757 with 549069 851	549120 (806)	*	*	*	Throat Plate Screw (2)
547759	*	*	*	Throat Plate Holder	549135 (810)	*	*	*	Shuttle Race Ring Cover Latch Screw (2)
547760	*	*	*	Throat Plate Holder 547759 with 65170	549701	*	*	*	Feed Dog
547767	*	*	*	Arm Shaft Bushing (intermediate)	549702	*	*	*	Shuttle Race (body)
547769	*	*	*	Arm Shaft Bushing (back)	549703	*	*	*	Shuttle Race complete, Nos. 549712, 547750, 549709 and two each 545325 (809) and 549066 (810)
547770	*	*	*	Arm Shaft Bushing (front)	549704	*	*	*	Throat Plate
547772	*	*	*	Shuttle Body with Cover	549709	*	*	*	Shuttle Race Ring
547774	*	*	*	Oscillating Shaft Crank complete, Nos. 547731, 547790, 549083 (809), 12424 and 545056 (833)	549710	*	*	*	Feed Regulating Stud Head
547775	*	*	*	Feed Rock Shaft	549711	*	*	*	Feed Regulating Stud Head 549710 with two Feed Regulating Stud Head Stop Plate
547776	*	*	*	Presser Bar Lifter Lever Spring	549712	*	*	*	Shuttle Race 549702 with 549067 (809) and 65169
547777	*	*	*	Shuttle Driver and Feed Lifting Cam	549713	*	*	*	Feed Dog
547780	*	*	*	Face Plate Thread Guard (lower)	549714	*	*	*	Feed Dog Carrier
547782	*	*	*	Feed Reverse Lever	549715	*	*	*	Throat Plate
547783	*	*	*	Feed Reverse Lever Return Spring Bracket	549717	*	*	*	Feed Regulating Stud Head
547789	*	*	*	Feed Dog	549718	*	*	*	Feed Regulating Stud Head 549717 with two Feed Regulating Stud Head Stop Plate
547790	*	*	*	Oscillating Shaft Crank Slide Block	<b>ACCESSORIES</b>				
547791	*	*	*	Oscillating Rock Shaft Oil Pad (felt)	<b>FOR MACHINES 17U130 AND 17U141</b>				
547792	*	*	*	Feed Reverse Lever Pitman	PART NO.	DESCRIPTION			
547793	*	*	*	Feed Regulating Stud Bushing	547794	Drip Pan			
547795	*	*	*	Arm Shaft 547703 with 547743, 547756 and 548416	547781	Feed Reverse Lever Chain			
547838	*	*	*	Needle Clamp 547852 with 549055 (858) and 547839	547778	Feed Reversing Treadle complete			
547839	*	*	*	Needle Clamp Thread Guide 547851 with 549054 (851)	547763	Guide (roller) complete, Nos. 547765 and 547764			
547851	*	*	*	Needle Clamp Thread Guide	547764	Guide Bracket			
547852	*	*	*	Needle Clamp (body)	547765	Guide Roller with 549070 (810)			
547853	*	*	*	Needle Bar Bushing (2)	549070 (810)	Guide Roller Screw Stud			
547853	*	*	*	Presser Bar Bushing	504004 (809)	Guide Thumb Screw			
547855	*	*	*	Cylinder Side Cover	549071 (809)	Machine Bolt (4)			
547960	*	*	*	Belt Safety Guard with two 504029 (833)	547766	Machine Bolt 549071 (809) with 545464 (809) and 6055			
547961	*	*	*	Belt Safety Guard Shaft	545464 (809)	Machine Bolt Nut (4)			
547963	*	*	*	Tension Releaser	6055	Machine Bolt Washer (4)			
548170	*	*	*	Oscillating Shaft Crank Pin	547773	Motor Treadle Lever			
548170	*	*	*	Shuttle Driver Pin	2083 (16x2)	Needle (6)			
548416	*	*	*	Thread Take-up Cam Pin	PN962	Oiler (filled with Singer Type "B" Oil)			
549051 (803)	*	*	*	Feed Rock Shaft Crank Position Screw	65164	Presser Foot (wide toe)			
549052 (803)	*	*	*	Needle Bar Connecting Link Hinge Screw	PN963	Screw Driver (large)			
					PN964	Screw Driver (small)			
					2073	Shuttle Bobbin (4)			
					4918	Wrench (for 545456)			
					547930	Wrench (for 154981)			
					547846	Wrench (for 545454 and 545455)			